

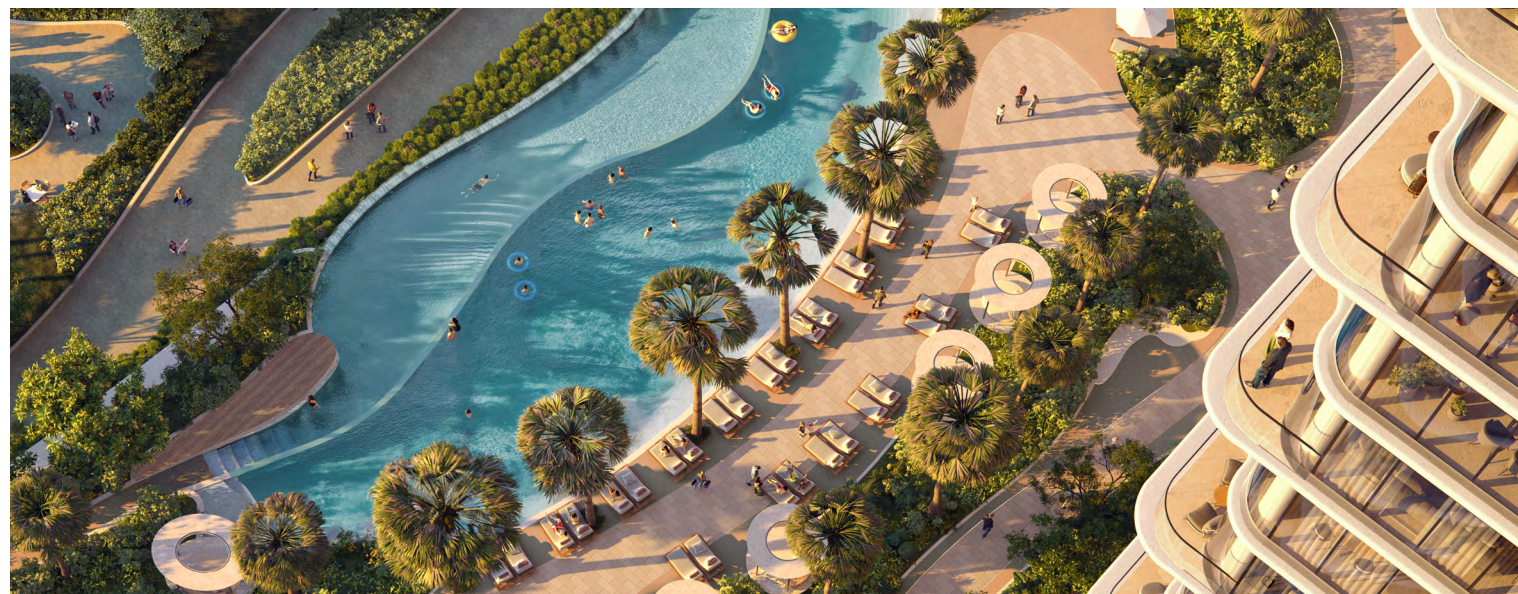

# THE EDIT<sup>AT</sup> d3

## Floor Plans

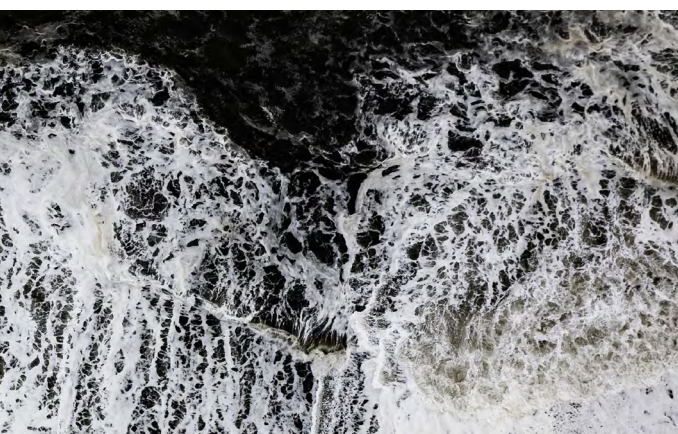



Tower



A

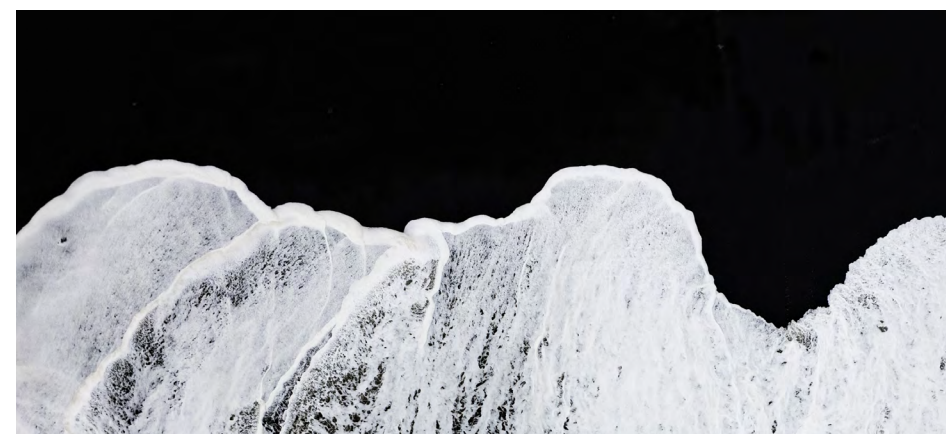



# 1-Bedroom

- Type A-1B-A.1

Unit Number			
102, 302, 502, 702, 902, 1102, 1302, 1702, 1902, 2102, 2302, 2502, 2702, 2902			
Unit Type		Suite Area N/A	SQM   SQFT
A-1B-A.1		63.56	684.15
Balcony Area	SQM   SQFT	Total Area NSA	SQM   SQFT
6.56	70.61	70.12	754.76

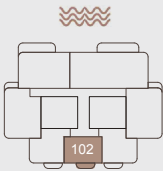
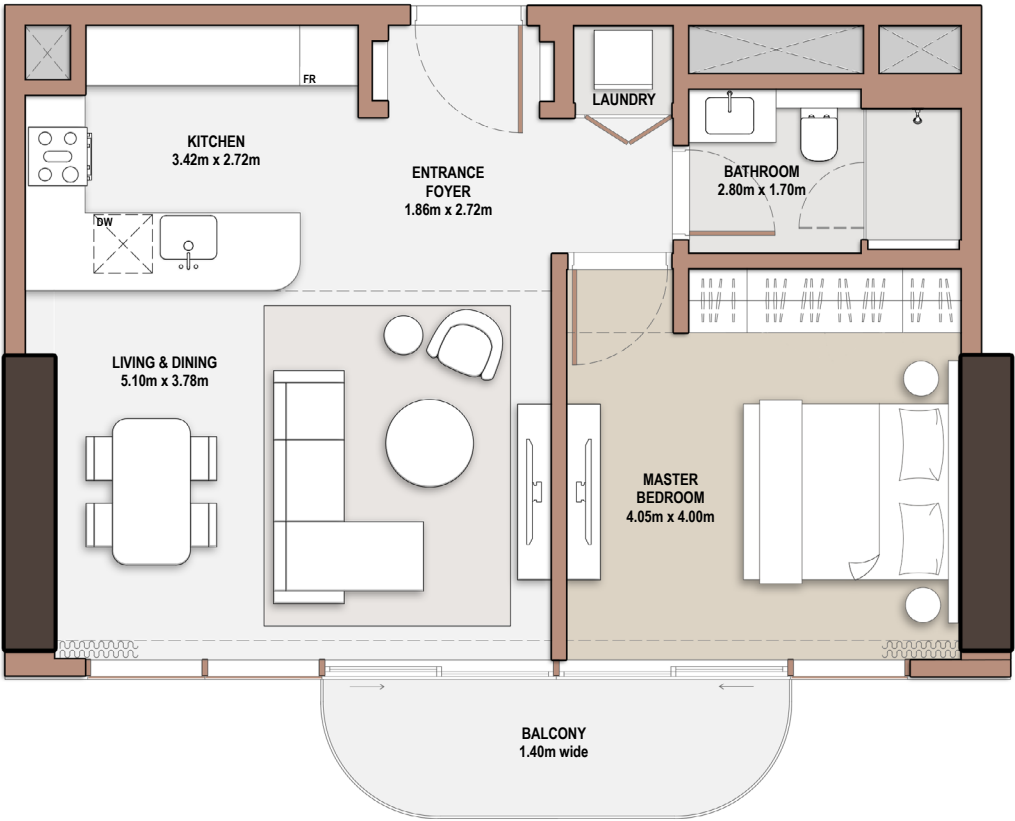

FLOOR 01

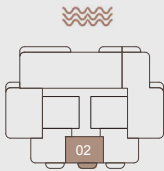

FLOOR 27 & 29

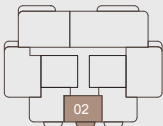

FLOOR 3, 5, 7, 11, 13, 17, 19, 21, 23

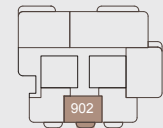

FLOOR 09

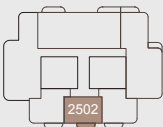

FLOOR 25

# 1-Bedroom

- Type A-1B-A.2

Unit Number			
202, 402, 602, 802, 1002, 1202, 1402, 1802, 2002, 2202, 2402, 2602, 2802			
Unit Type		Suite Area N/A	
A-1B-A.2		SQM	SQFT
		63.71	685.77
Balcony Area		Total Area NSA	
		SQM	SQFT
6.40		70.11	754.66

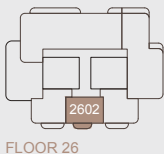
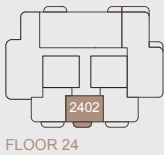
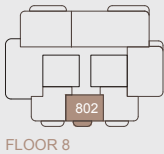
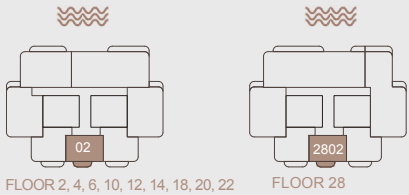
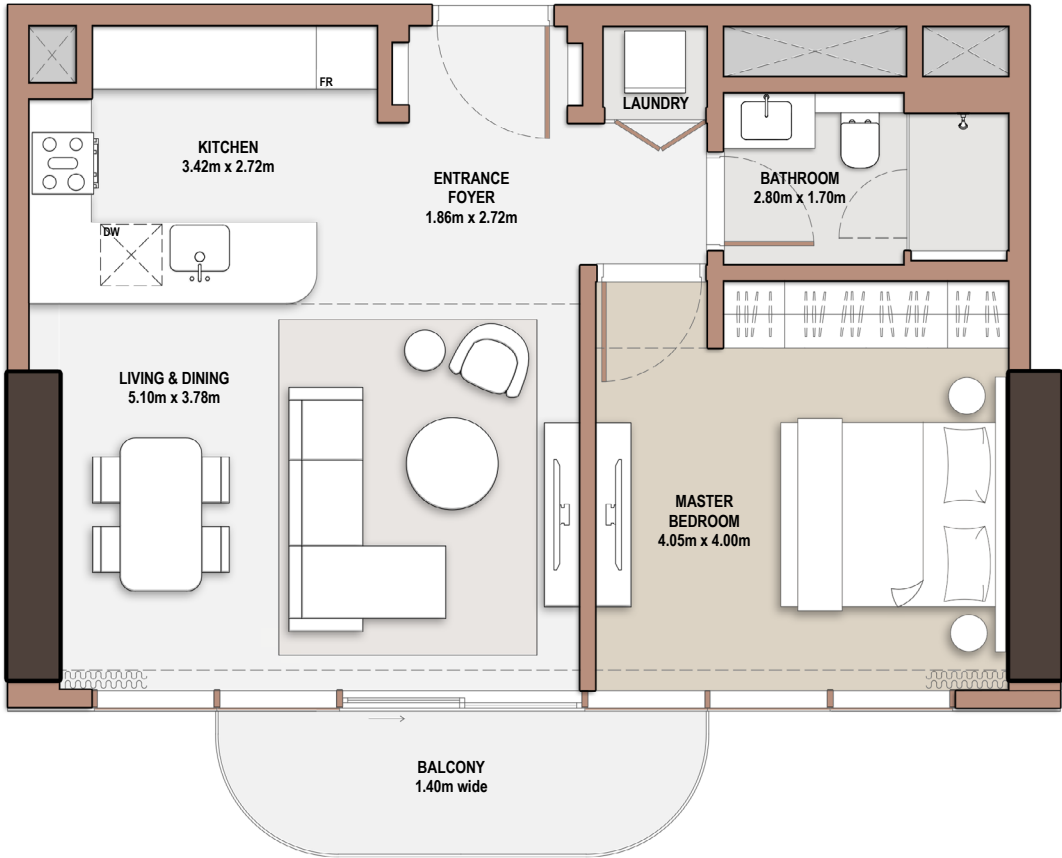



# 1-Bedroom

- *Type* A-1B-B.1

Unit Number			
101, 301, 501, 701, 901, 1101, 1301, 1701, 1901, 2101, 2301, 2501, 2701, 2901			
Unit Type		Suite Area N/A	SQM   SQFT
A-1B-B.1		72.75	783.07
Balcony Area	SQM   SQFT	Total Area NSA	SQM   SQFT
6.69	72.01	79.44	855.08

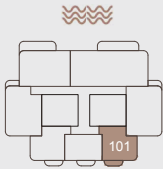

FLOOR 01

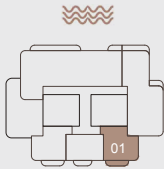

FLOOR 27 & 29

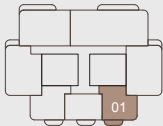

FLOOR 3, 5, 7, 11, 13, 17, 19, 21, 23

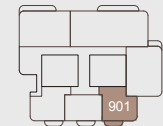

FLOOR 09

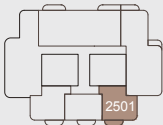

FLOOR 25

# 1-Bedroom

- Type A-1B-B.2

Unit Number			
201, 401, 601, 801, 1001, 1201, 1401, 1801, 2001, 2201, 2401, 2601, 2801			
Unit Type	Suite Area N/A		
A-1B-B.2	72.75   783.07		
Balcony Area	SQM   SQFT	Total Area NSA	SQM   SQFT
8.35   89.88		81.10   872.95	

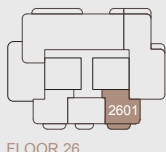
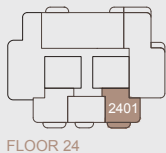
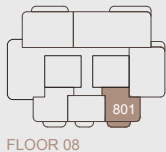
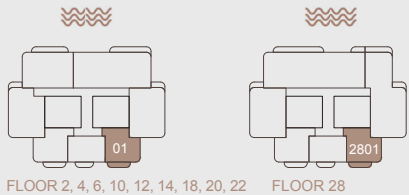

# 1-Bedroom

- *Type* A-1B-C.1

Unit Number			
103, 303, 503, 703, 903, 1103, 1303, 1703, 1903, 2103, 2303, 2503, 2703, 2903			
Unit Type	Suite Area N/A		
A-1B-C.1	74.72	SQM	804.28
Balcony Area	Total Area NSA		
6.64	71.47	SQM	875.75

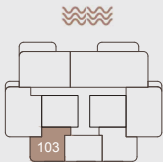

FLOOR 01

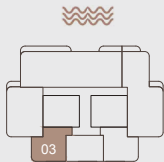

FLOOR 27 & 29

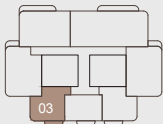

FLOOR 3, 5, 7, 11, 13, 17, 19, 21, 23



FLOOR 09

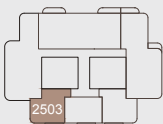

FLOOR 25



# 1-Bedroom

- Type A-1B-C.2

Unit Number			
203, 403, 603, 803, 1003, 1203, 1403, 1803, 2003, 2203, 2403, 2603, 2803			
Unit Type	Suite Area N/A		
A-1B-C.2	74.72   804.28		
Balcony Area	SQM   SQFT	Total Area NSA	SQM   SQFT
8.36   89.99		83.08   894.26	

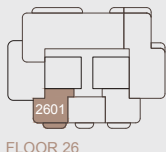
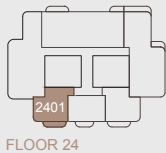
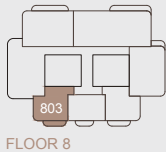
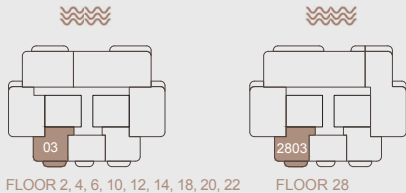

# 2-Bedroom

- *Type* A-2B-A.1

Unit Number			
104, 204, 304, 404, 504, 604, 704, 1004, 1104, 1204, 1304, 1404, 1704, 1804, 1904, 2004, 2104, 2204, 2304			
Unit Type	Suite Area NIA      SQM   SQFT		
A-2B-A.1	112.16   1,207.28		
Balcony Area	SQM   SQFT	Total Area NSA	SQM   SQFT
5.48   58.99		117.64   1,266.27	

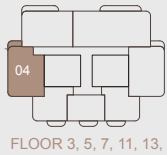
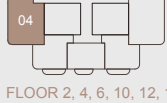
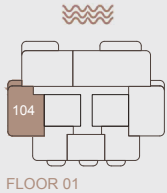
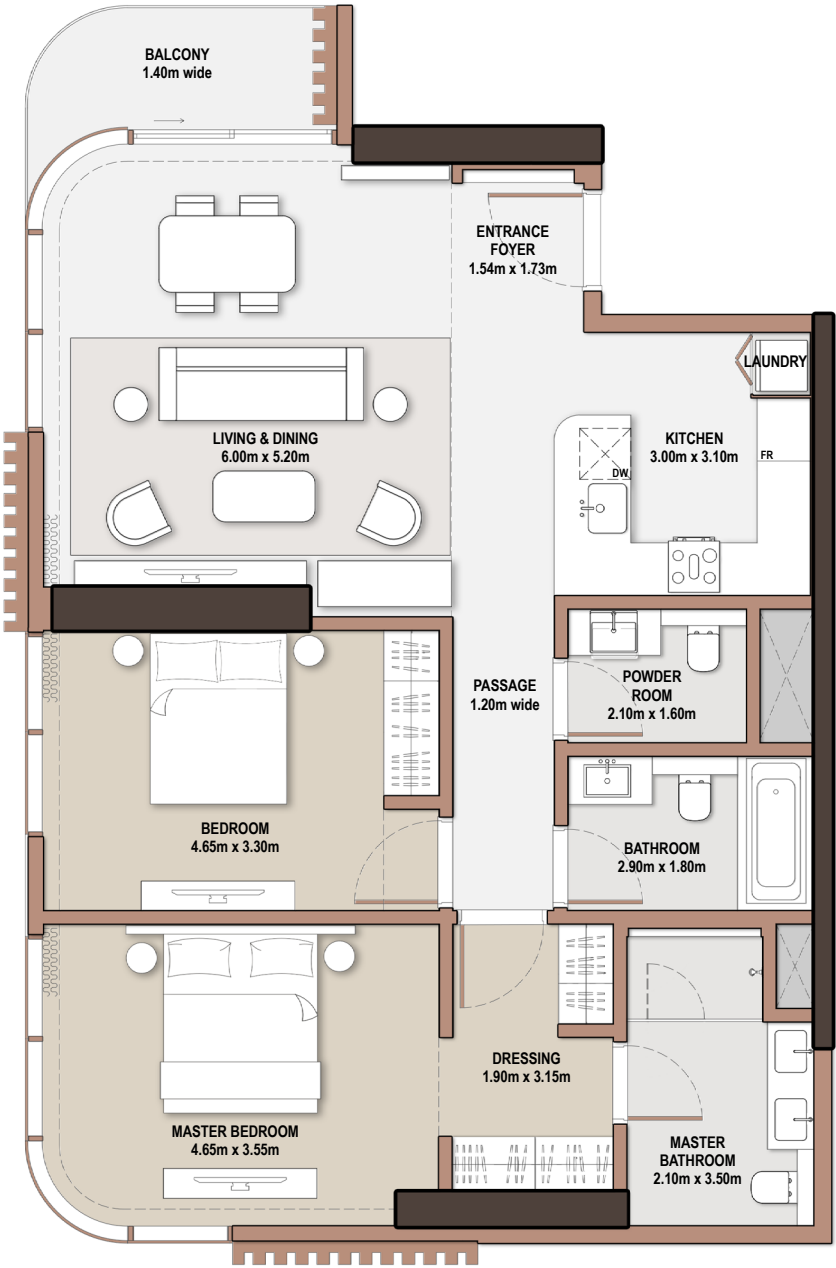

# 2-Bedroom

- Type A-2B-B.1

Unit Number			
107, 207, 307, 407, 507, 607, 707, 806, 906, 1007, 1107, 1207, 1307, 1407, 1707, 1807, 1907, 2007, 2107, 2207, 2307			
Unit Type	Suite Area NIA      SQM   SQFT		
A-2B-B.1	118.11   1,271.32		
Balcony Area	SQM   SQFT	Total Area NSA	SQM   SQFT
5.48   58.99		123.59   1,330.31	

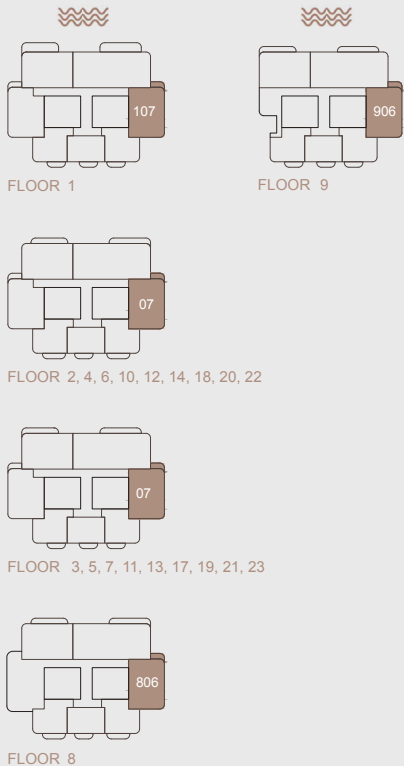
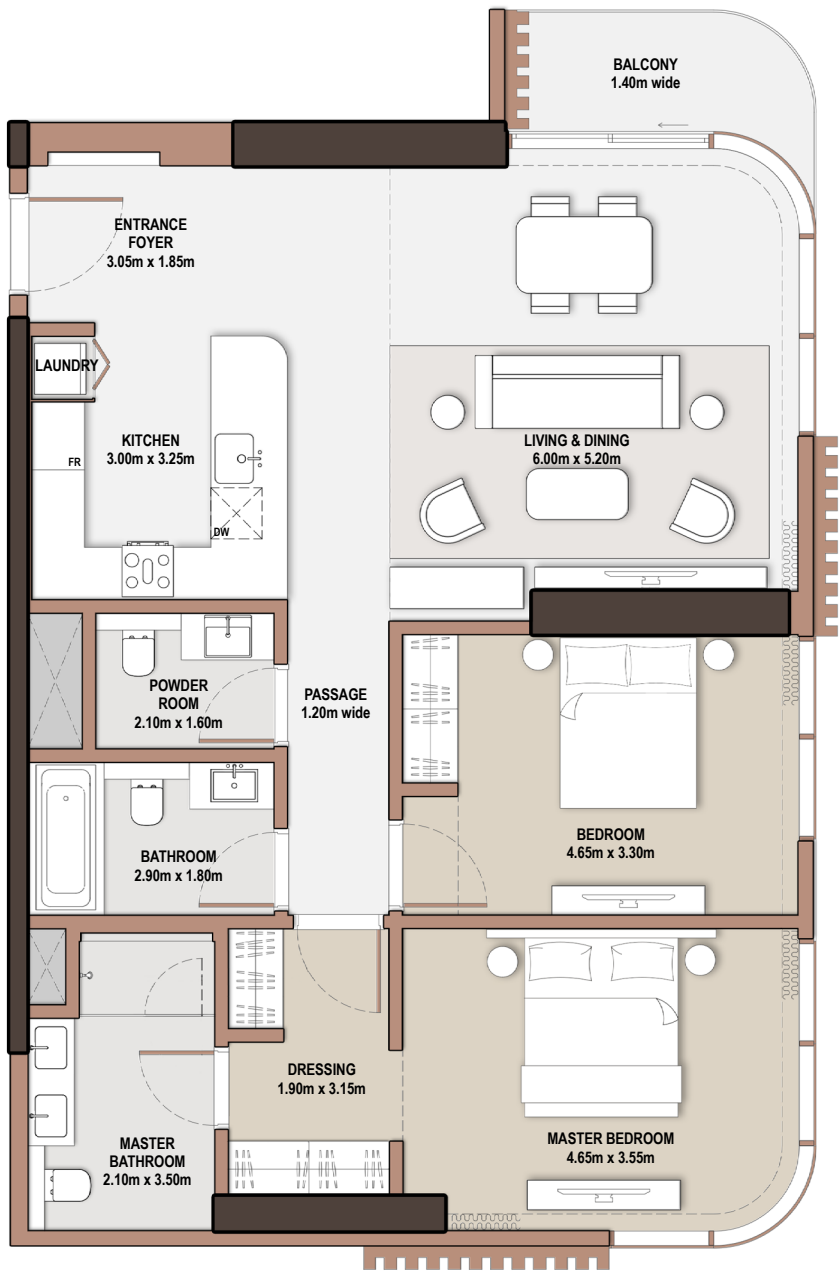



# 2-Bedroom

- *Type* A-2B-C.1

Unit Number			
2704, 2804, 2904			
Unit Type		Suite Area N/A	SQM   SQFT
A-2B-C.1		117.84	1,268.42
Balcony Area	SQM   SQFT	Total Area NSA	SQM   SQFT
5.48	58.99	123.32	1,327.40

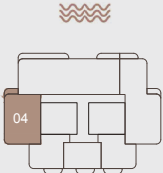
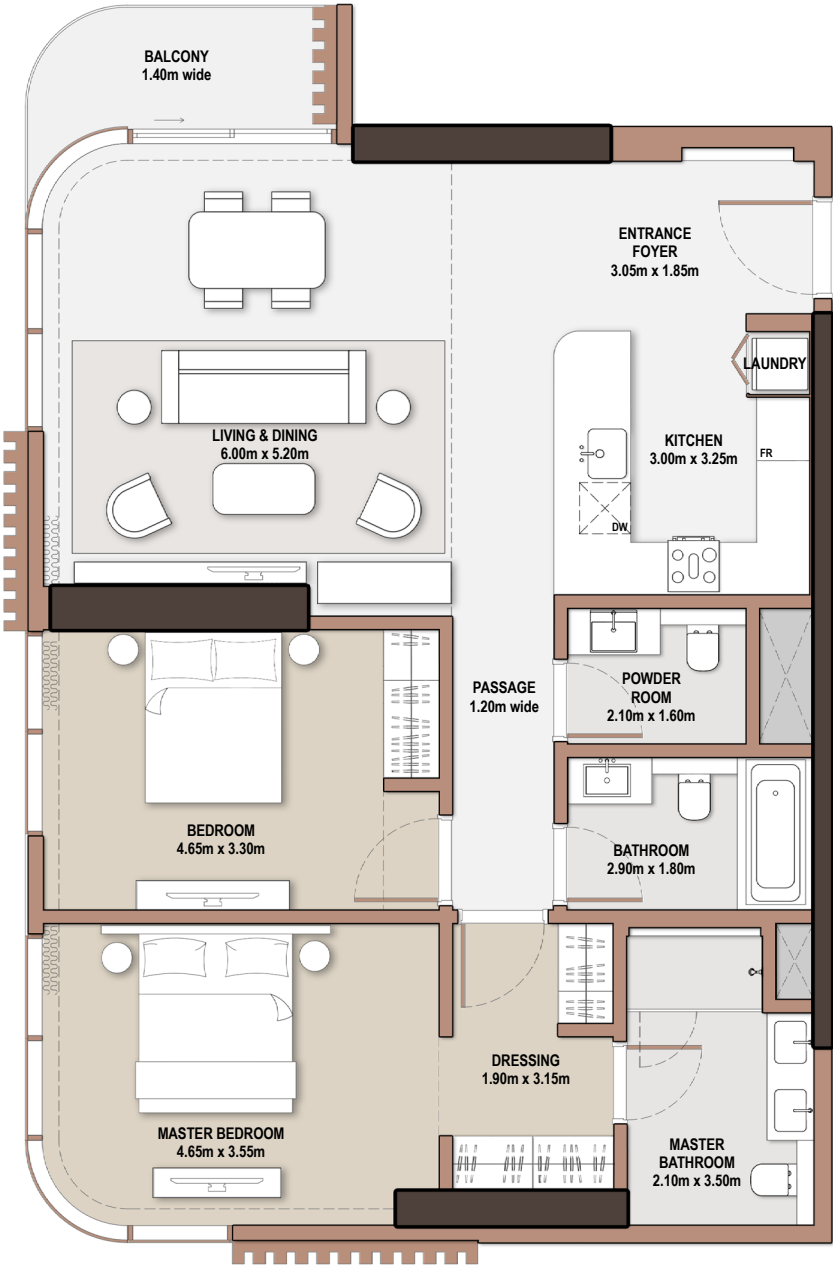

FLOOR 27, 29

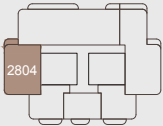

FLOOR 28

# 2-Bedroom

- Type A-2B-D.1

Unit Number		1603	
Unit Type	A-2B-D.1	Suite Area N/A	SQM   SQFT
		117.92	1,269.28
Balcony Area	SQM   SQFT	Total Area NSA	SQM   SQFT
5.48	58.99	123.40	1,328.27

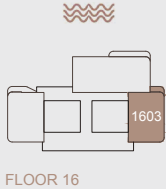
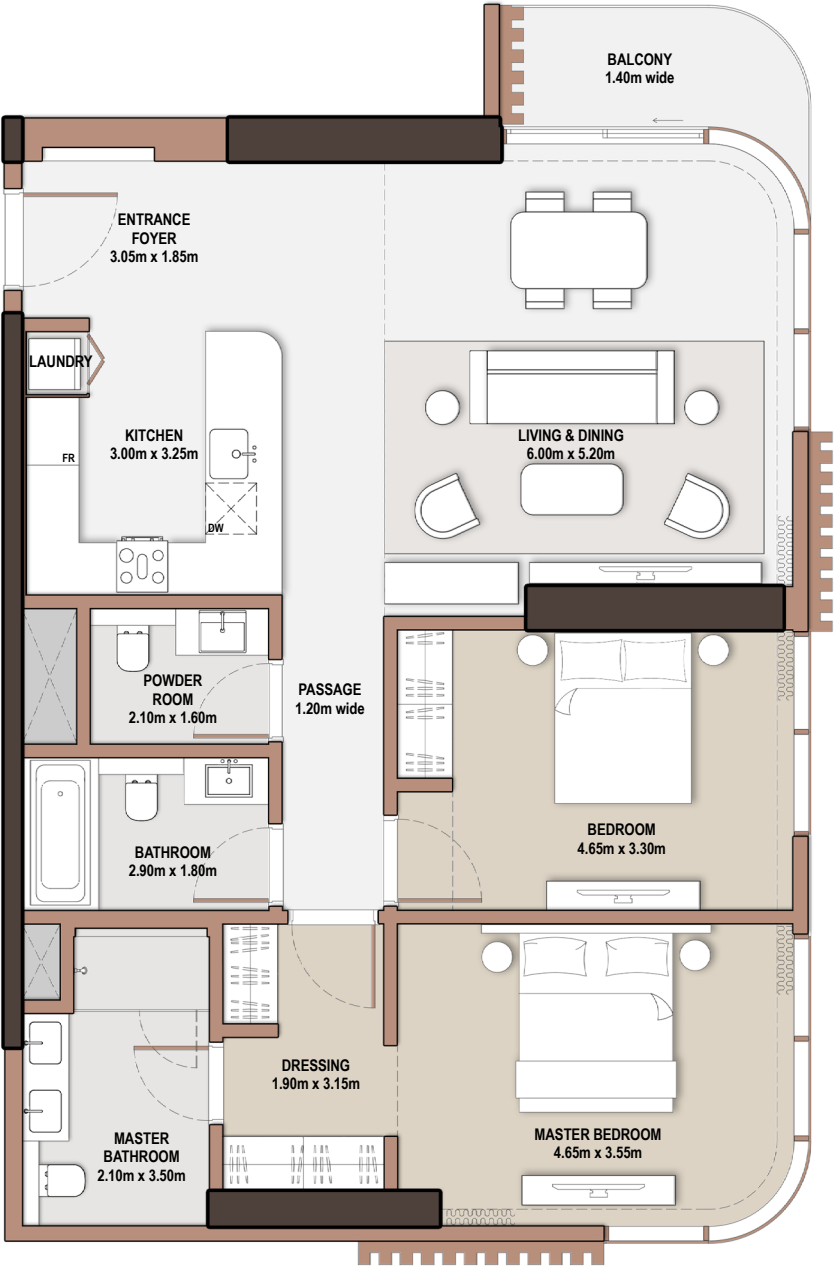

FLOOR 16

# 2-Bedroom

- Type A-2B-E.1

Unit Number			
1601			
Unit Type		Suite Area N/A	SQM   SQFT
A-2B-E.1		118.75	1,278.21
Balcony Area	SQM   SQFT	Total Area NSA	SQM   SQFT
8.89	95.69	127.64	1,373.90

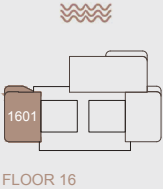
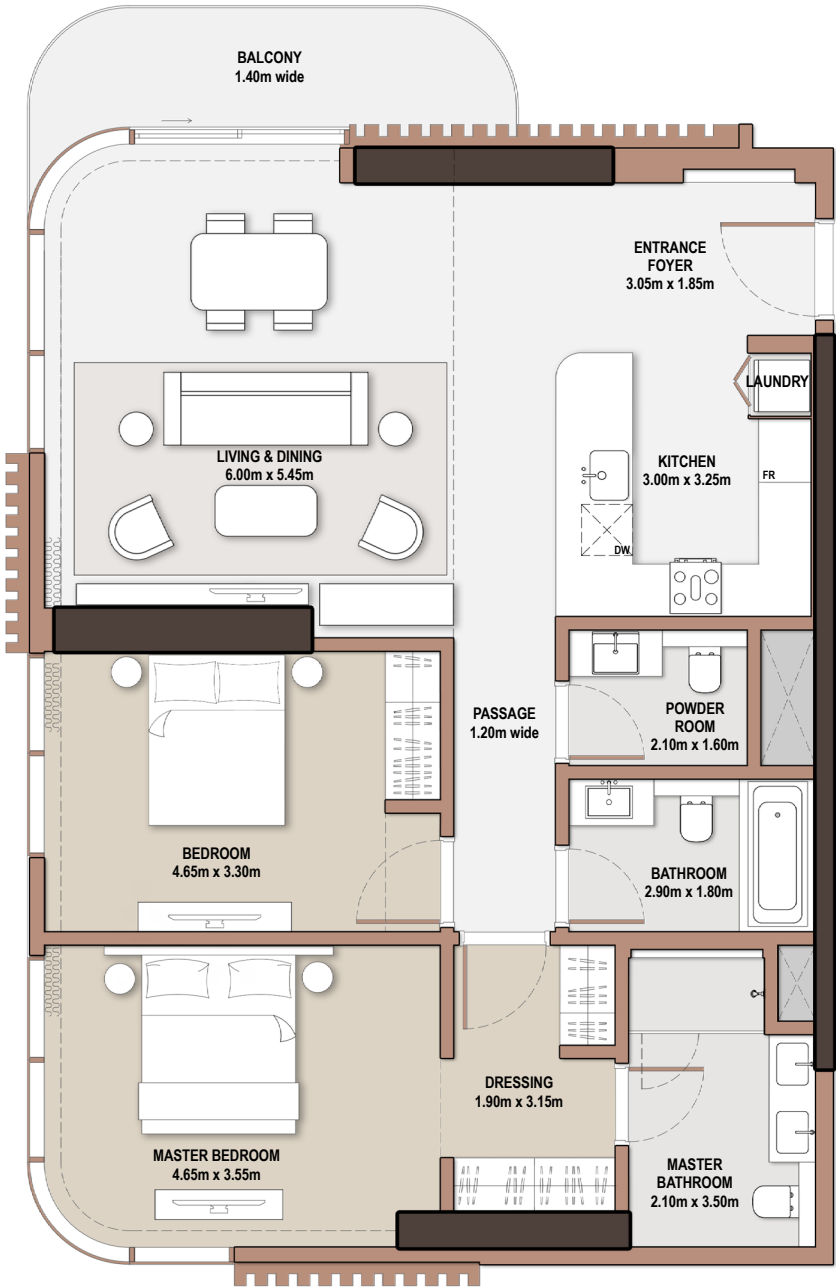



# 2-Bedroom

- Type A-2BM-A.1

Unit Number			
205, 405, 605, 804, 1005, 1205, 1405, 1805, 2005, 2205			
Unit Type	Suite Area N/A	SQM   SQFT	
A-2BM-A.1	120.34		1,295.33
Balcony Area	SQM   SQFT	Total Area NSA	SQM   SQFT
13.77	148.22	134.11	1,443.55

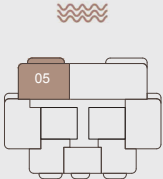
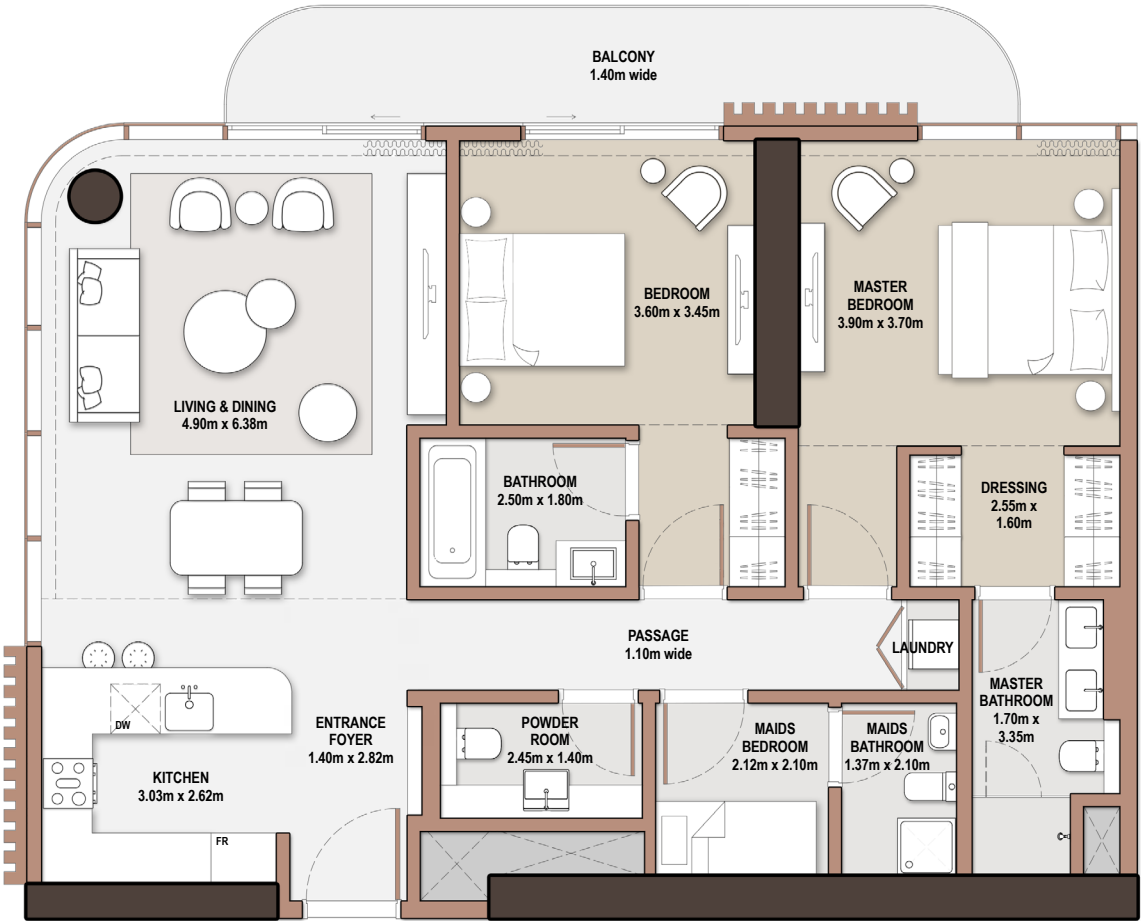

FLOOR 2, 4, 6, 10, 12, 14, 18, 20, 22

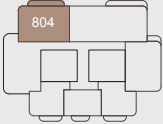

FLOOR 8

# 2-Bedroom

- *Type* A-2BM-A.2

Unit Number			
305, 505, 705, 904, 1105, 1305, 1705, 1905, 2105, 2305			
Unit Type	Suite Area N/A	SQM   SQFT	
A-2BM-A.2	120.34		1,295.33
Balcony Area	SQM   SQFT	Total Area NSA	SQM   SQFT
13.97	150.37	134.31	1,445.70

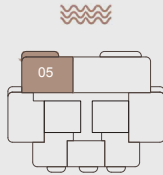
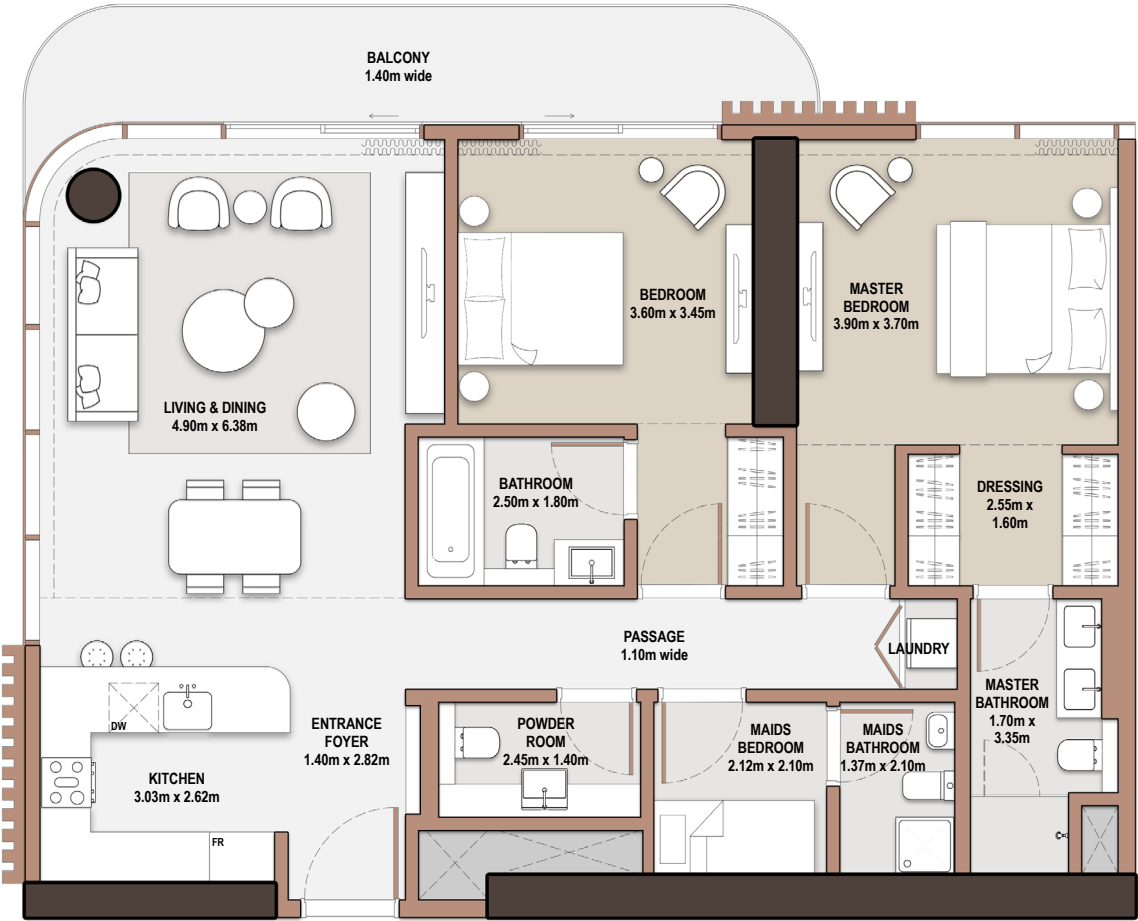

FLOOR 3, 5, 7, 11, 13, 17, 19, 21, 23

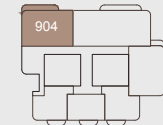

FLOOR 9

# 2-Bedroom

- *Type* A-2BM-A.3

Unit Number			
105			
Unit Type	Suite Area N/A		
A-2BM-A.3	SQM   SQFT	120.34   1,295.33	
Balcony Area	SQM   SQFT	Total Area NSA	SQM   SQFT
23.59   253.92		143.93   1,549.25	

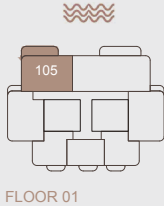
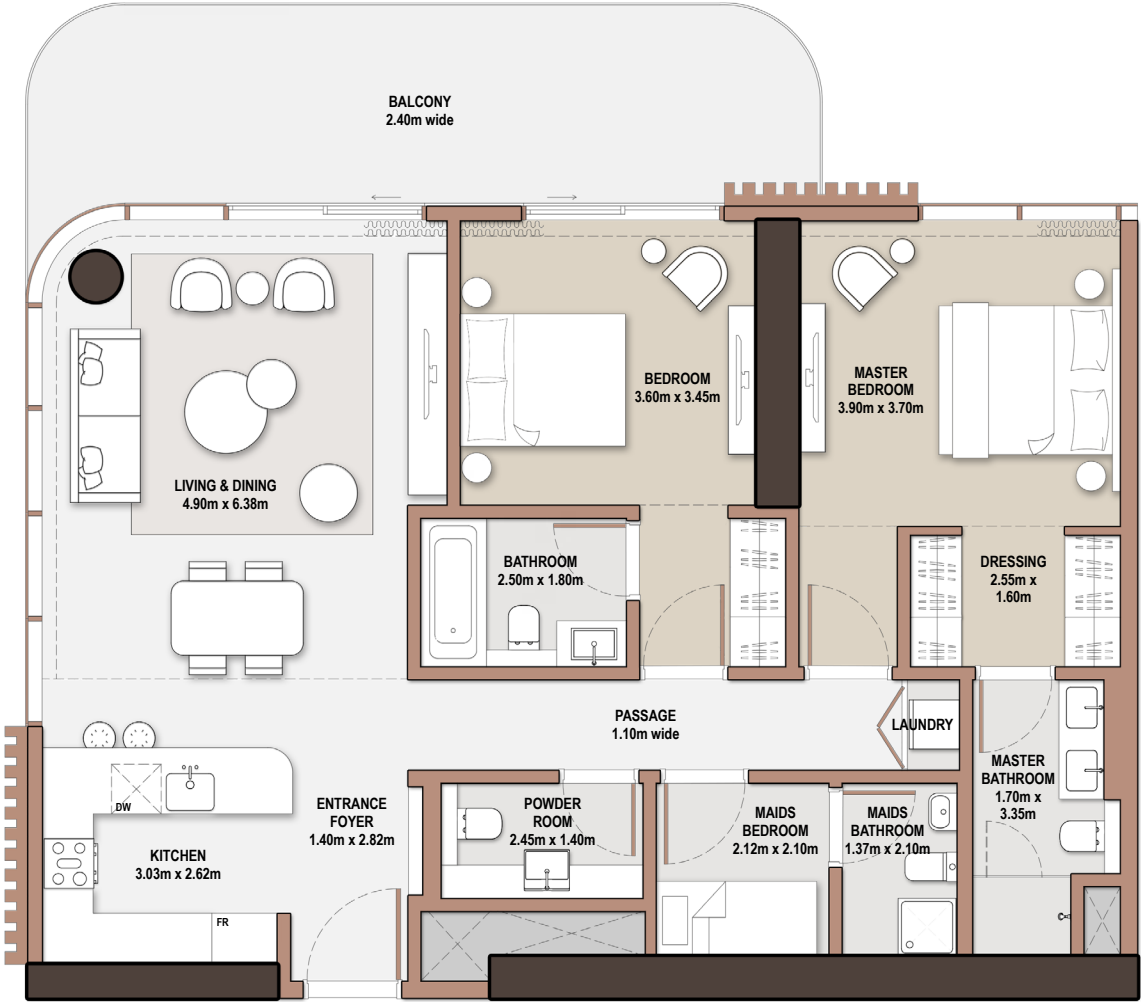



# 3-Bedroom

- Type A-3B-A.1

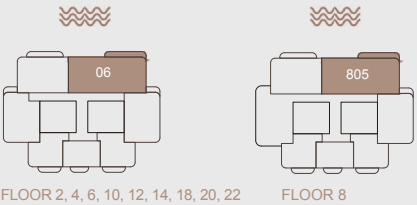

Unit Number			
206, 406, 606, 805, 1006, 1206, 1406, 1806, 2006, 2206			
Unit Type	Suite Area N/A	SQM   SQFT	
A-3B-A.1	184.39	1,984.76	
Balcony Area	SQM   SQFT	Total Area NSA	SQM   SQFT
15.68   168.78		200.07	2,153.53

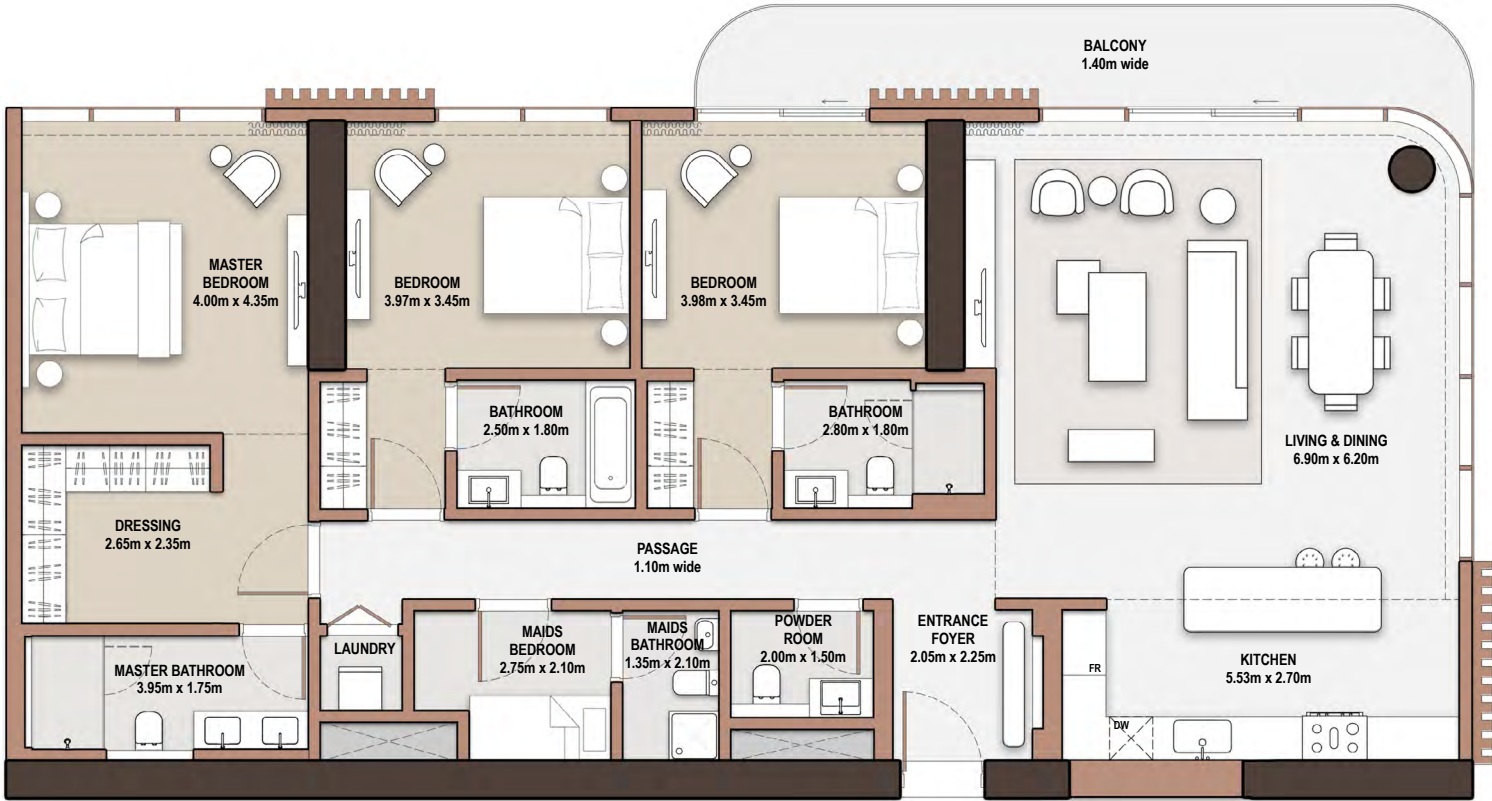

# 3-Bedroom

- Type A-3B-A.2

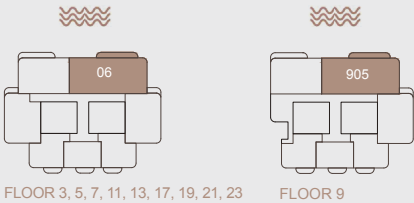

Unit Number			
306, 506, 706, 905, 1106, 1306, 1706, 1906, 2106, 2306			
Unit Type	Suite Area N/A	SQM   SQFT	
A-3B-A.2	184.39	1,984.76	
Balcony Area	SQM   SQFT	Total Area NSA	SQM   SQFT
15.48	166.63	199.87	2,151.38

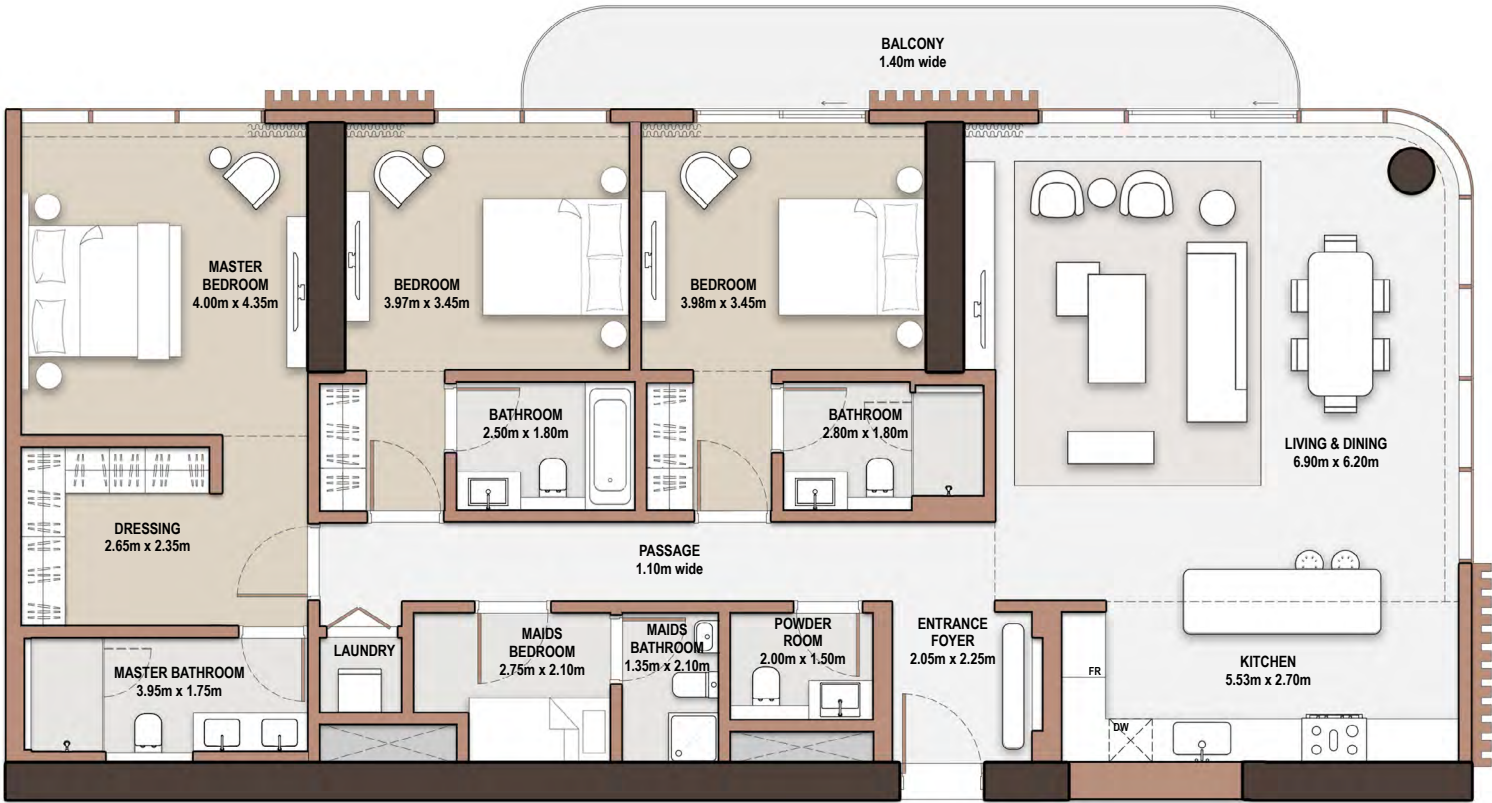

# 3-Bedroom

- Type A-3B-A.3

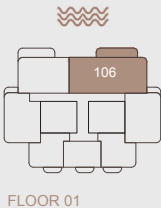

Unit Number			
106			
Unit Type	Suite Area N/A	SQM   SQFT	
A-3B-A.3	184.39		1,984.76
Balcony Area	SQM   SQFT	Total Area NSA	SQM   SQFT
26.28	282.88	210.67	2,267.63

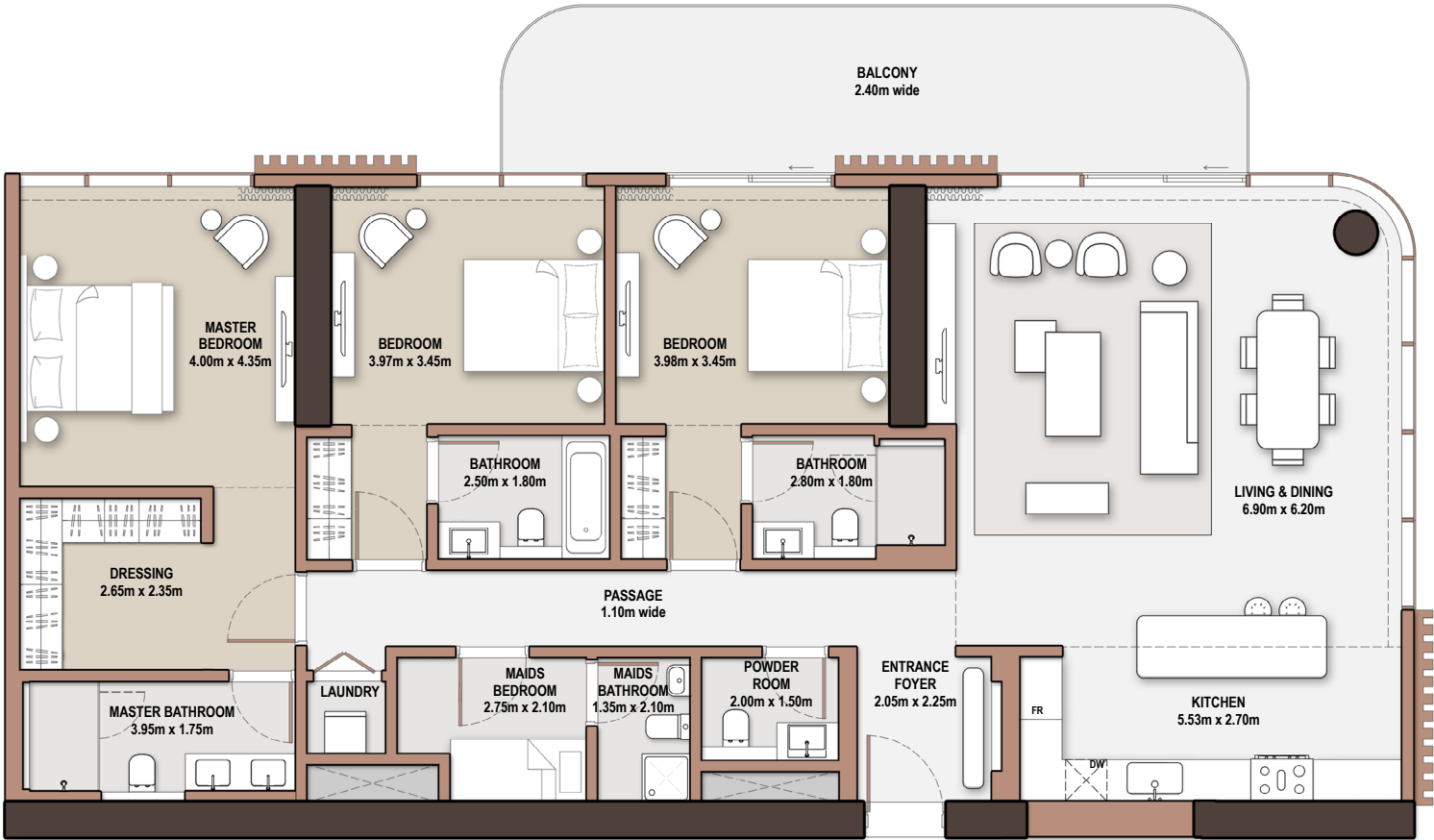

# 3-Bedroom

- *Type* A-3B-B.1

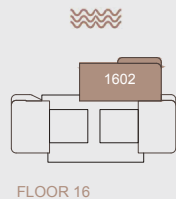

Unit Number		1602	
Unit Type	Suite Area N/A	SQM   SQFT	
A-3B-B.1	184.85		1,989.71
Balcony Area	SQM   SQFT	Total Area NSA	SQM   SQFT
15.68   168.78		200.53	2,158.48

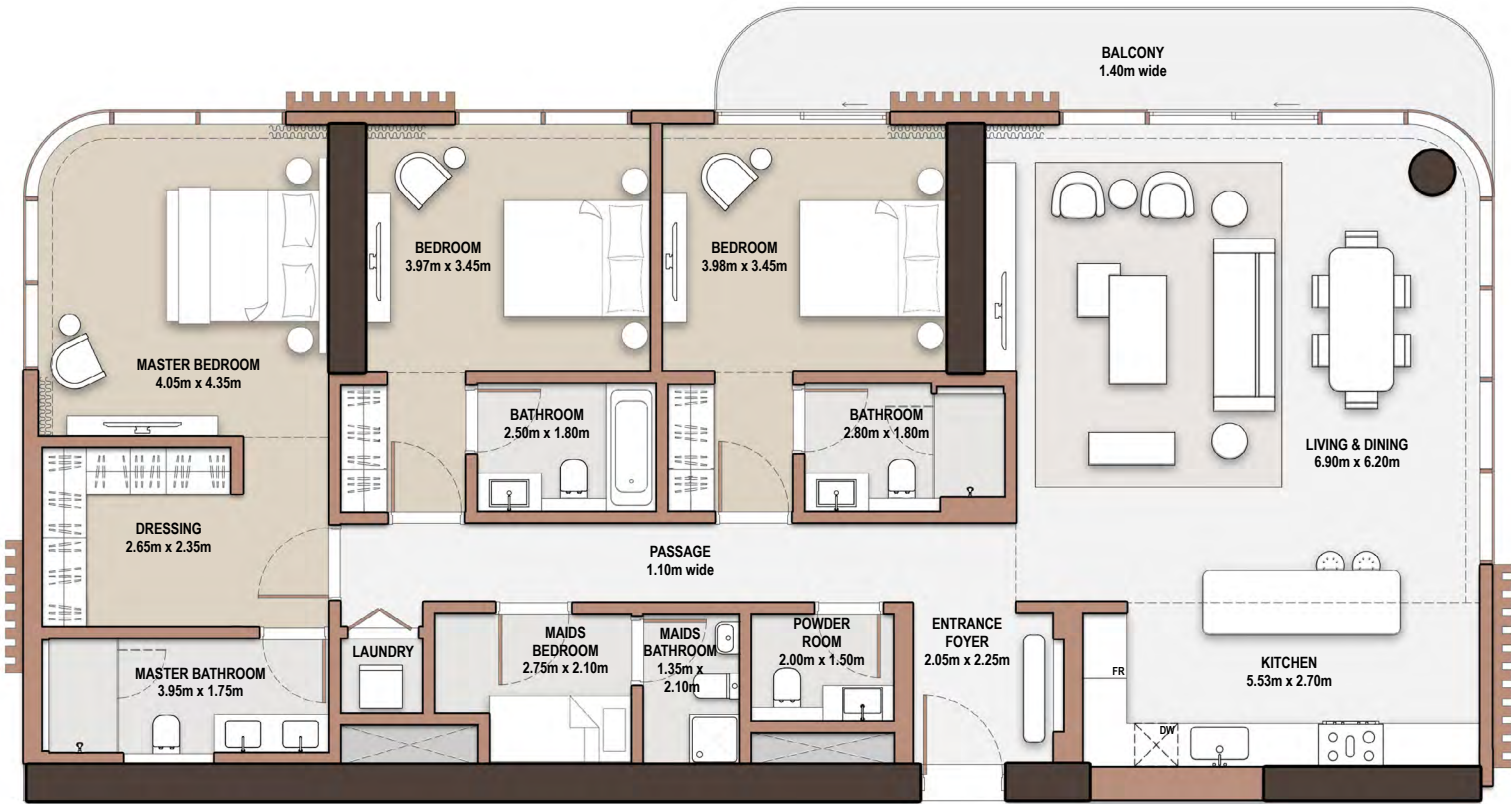



# 3-Bedroom

- *Type* A-3B-C.1

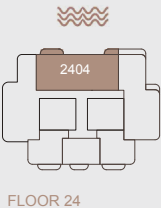

Unit Number		2404	
Unit Type	Suite Area N/A	SQM   SQFT	
A-3B-C.1	187.97	2,023.29	
Balcony Area	SQM   SQFT	Total Area NSA	SQM   SQFT
13.21   142.19		201.18	2,165.48

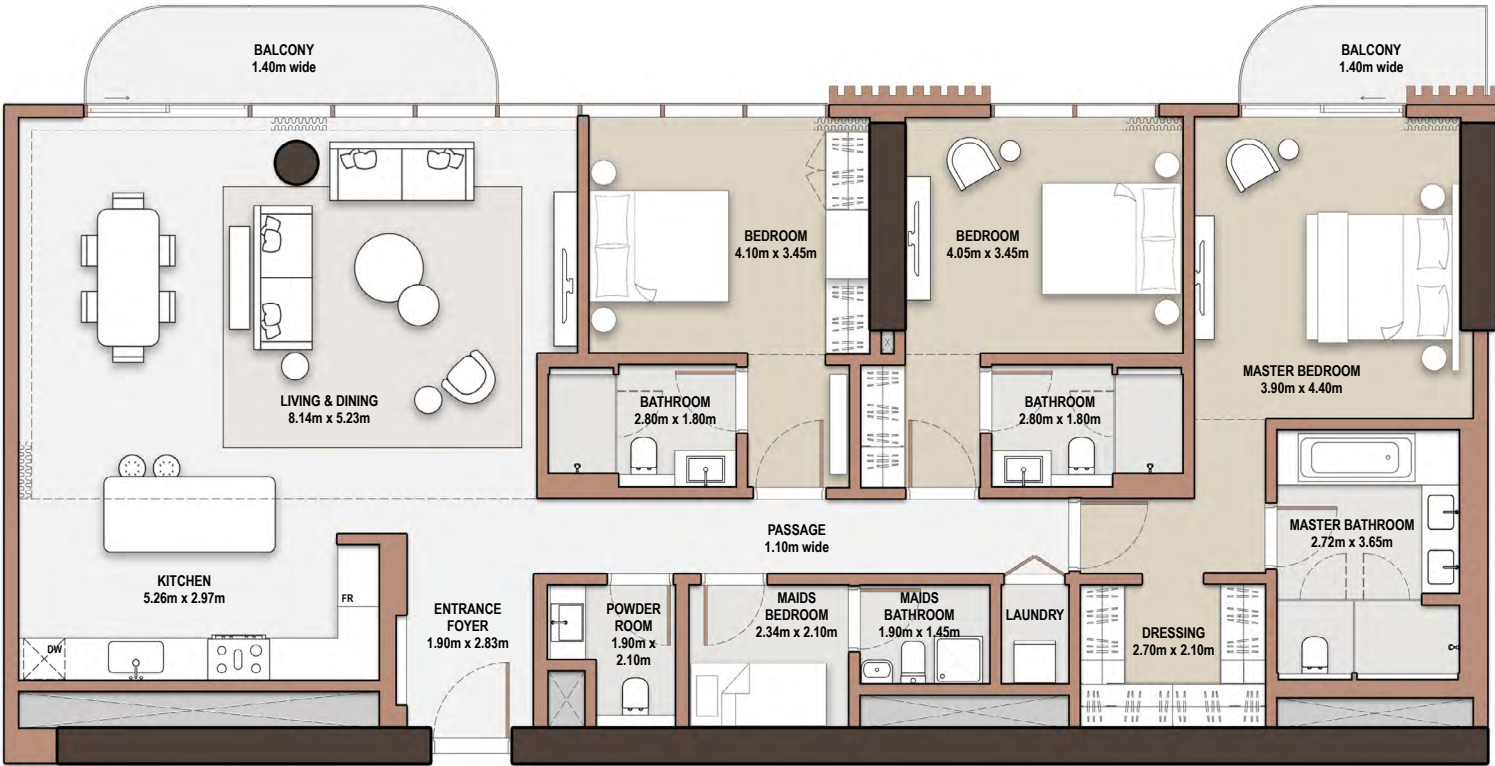



# 3-Bedroom

- *Type* A-3B-C.2

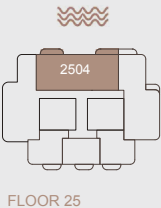

Unit Number		2504	
Unit Type	Suite Area NIA	SQM   SQFT	
A-3B-C.2	187.97	2,023.29	
Balcony Area	Total Area NSA	SQM   SQFT	
16.75   180.30	204.72	2,203.59	

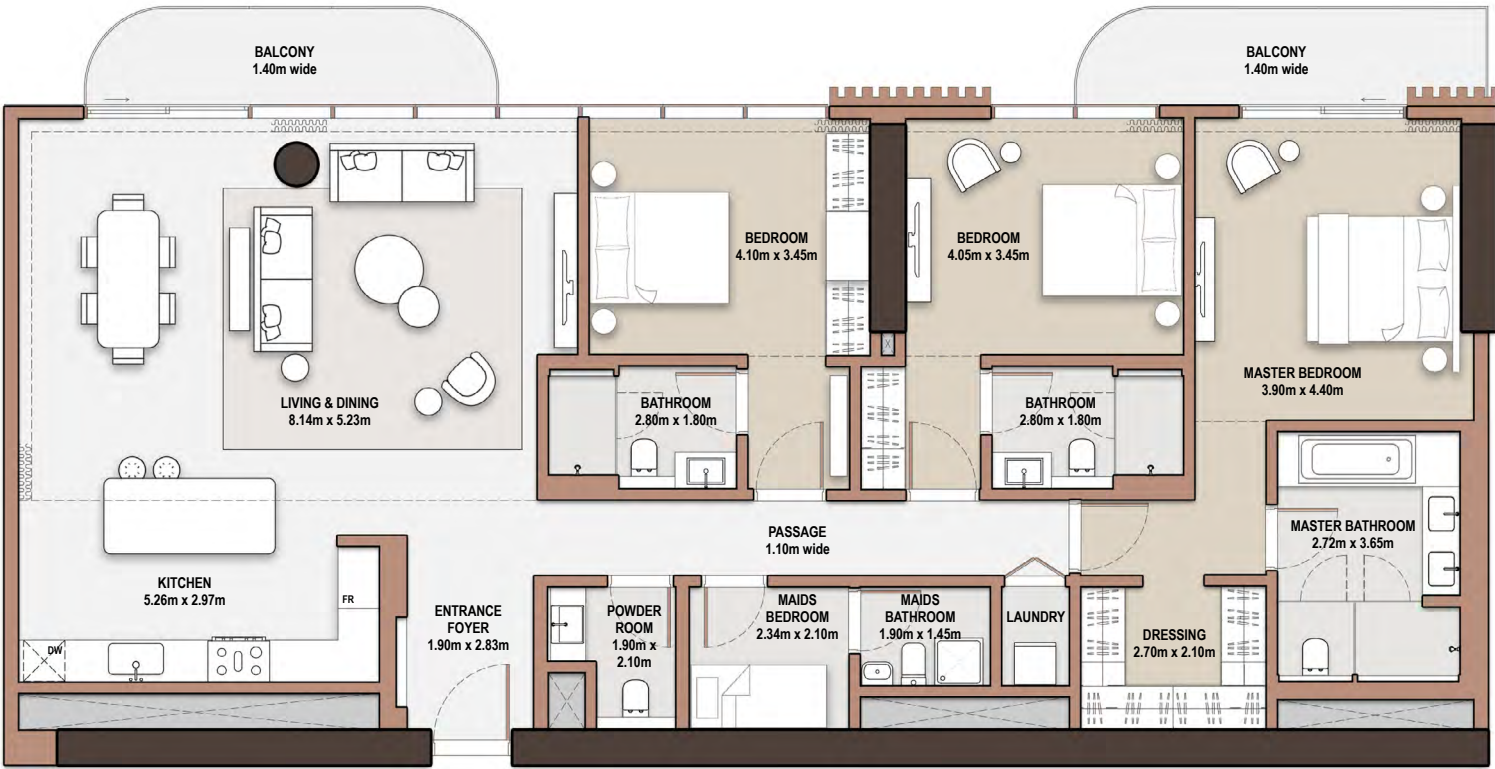

# 3-Bedroom

- *Type* A-3B-D.1

Unit Number			
2405, 2605, 2806			
Unit Type		Suite Area NIA	SQM   SQFT
A-3B-D.1		185.29	1,994.44
Balcony Area	SQM   SQFT	Total Area NSA	SQM   SQFT
16.07	172.98	201.36	2,167.42

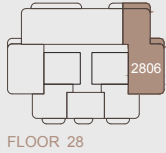
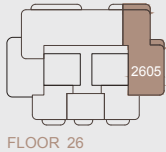
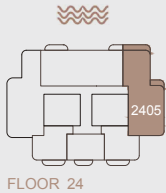
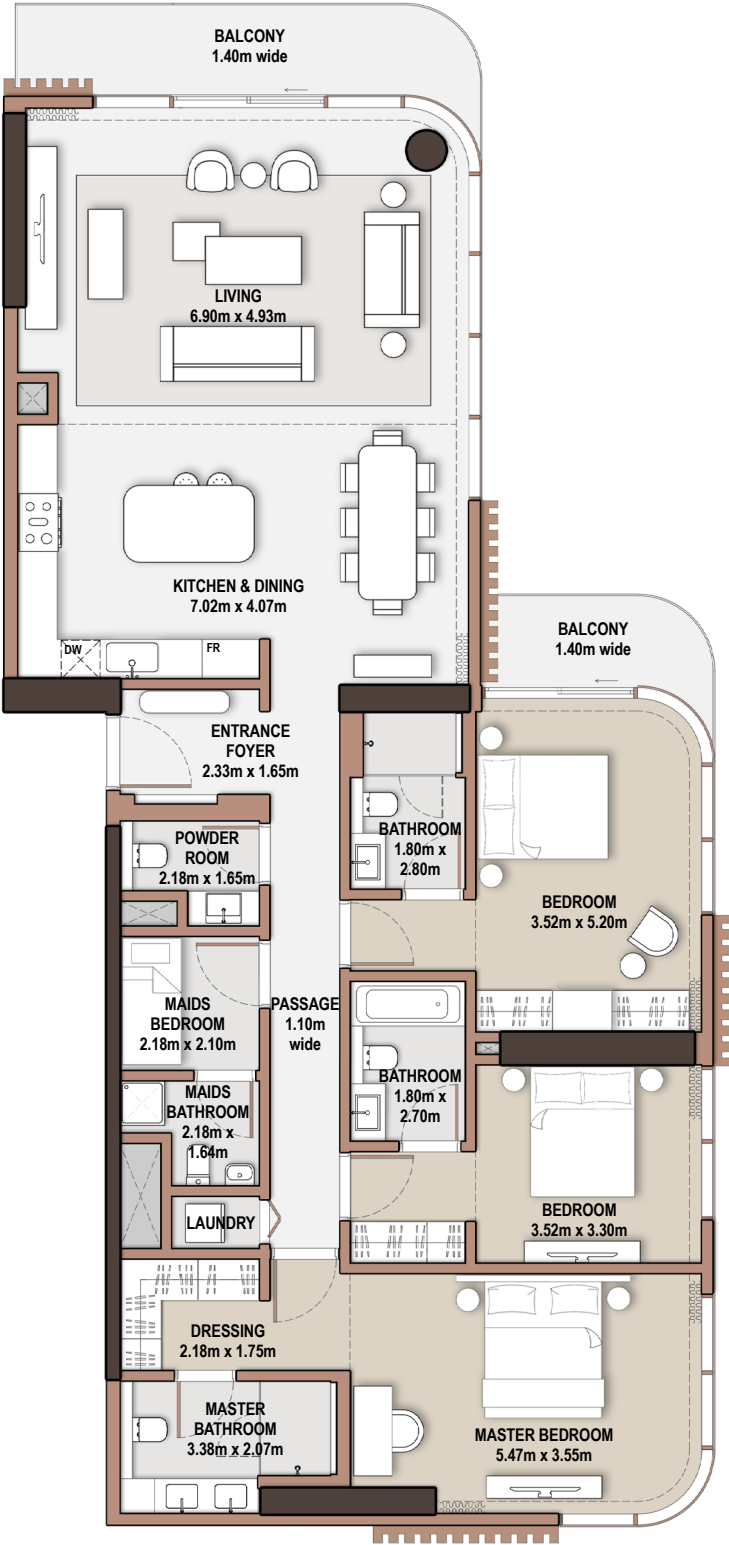

# 3-Bedroom

- *Type* A-3B-D.2

Unit Number			
2505, 2706, 2906			
Unit Type		Suite Area NIA	
A-3B-D.2		185.29   1,994.44	
Balcony Area		Total Area NSA	
12.32   132.61		197.61   2,127.05	

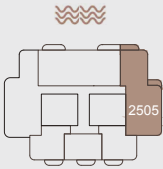
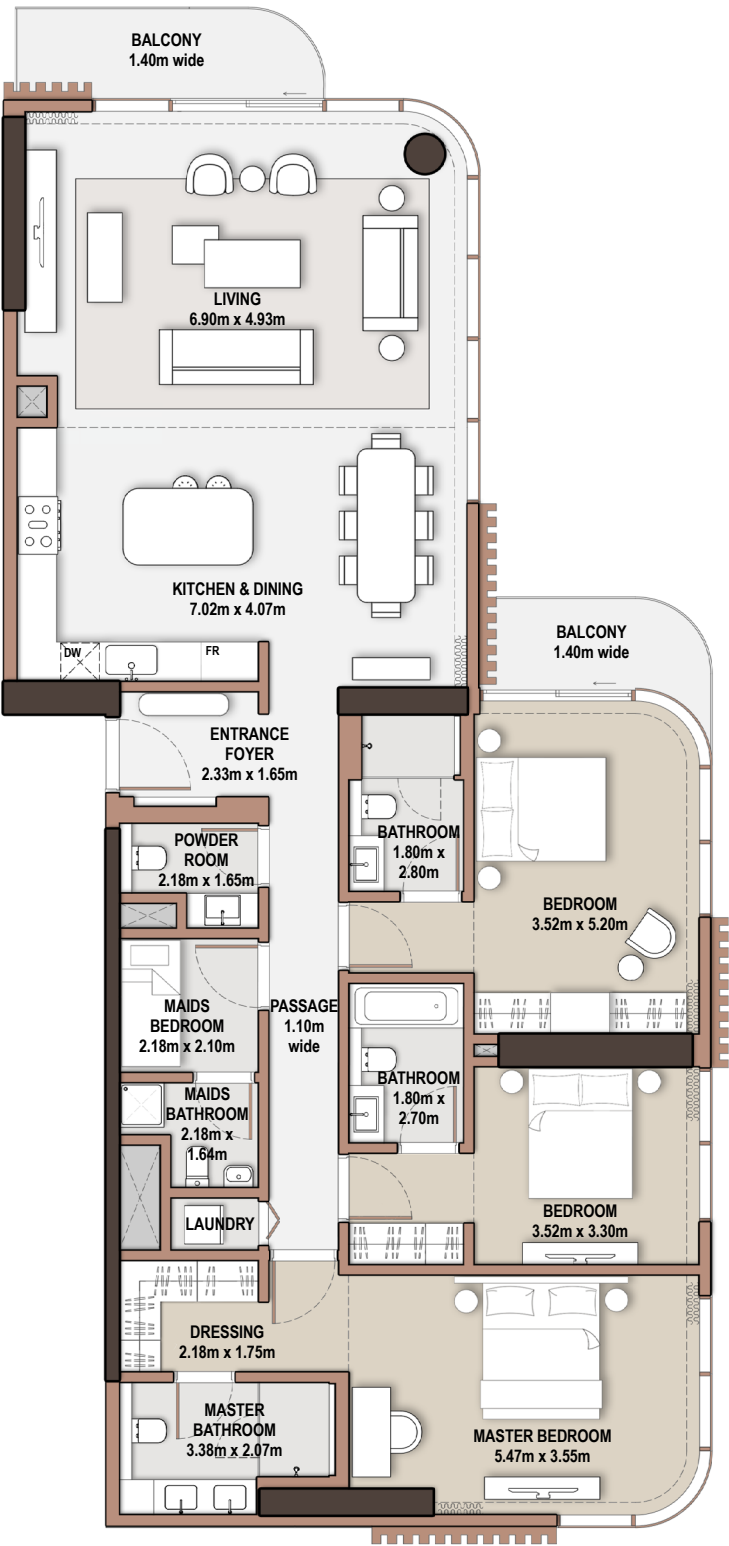

FLOOR 25

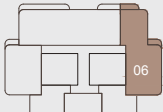

FLOOR 27, 29

# 4-Bedroom

- Type A-4B-A.1

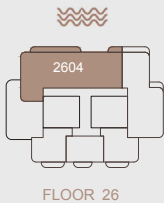

Unit Number			
2604			
Unit Type		Suite Area N/A	SQM   SQFT
A-4B-A.1		252.49	2,717.78
Balcony Area	SQM   SQFT	Total Area NSA	SQM   SQFT
23.91	257.36	276.40	2,975.14

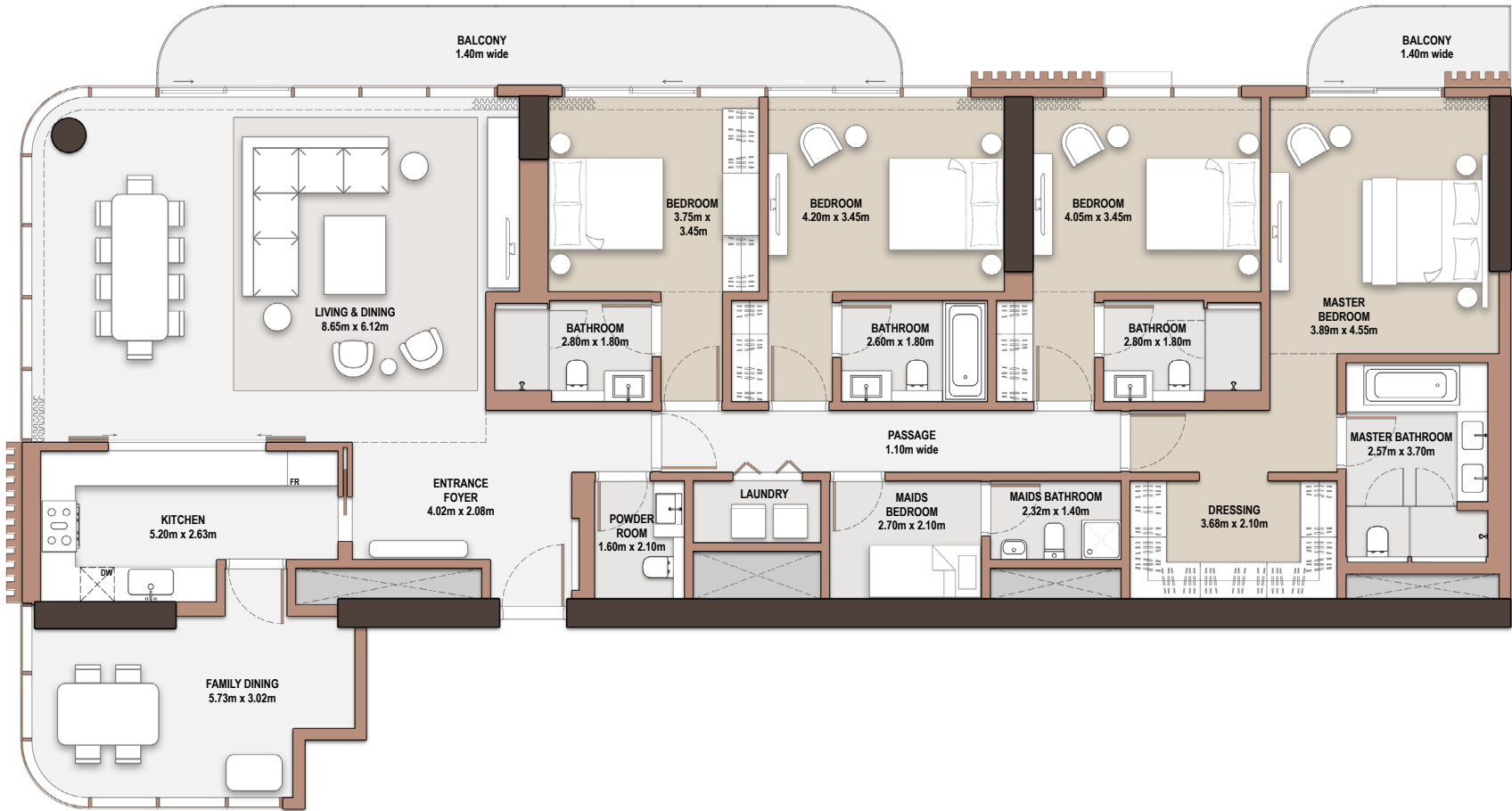

# 4-Bedroom

- *Type* A-4B-B.1

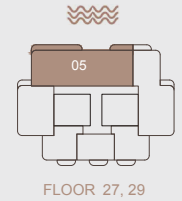

Unit Number 2705, 2905			
Unit Type A-4B-B.1	Suite Area NIA 233.70	SQM   SQFT 2,515.52	
Balcony Area 27.62	Total Area NSA 261.32	SQM   SQFT 2,812.82	

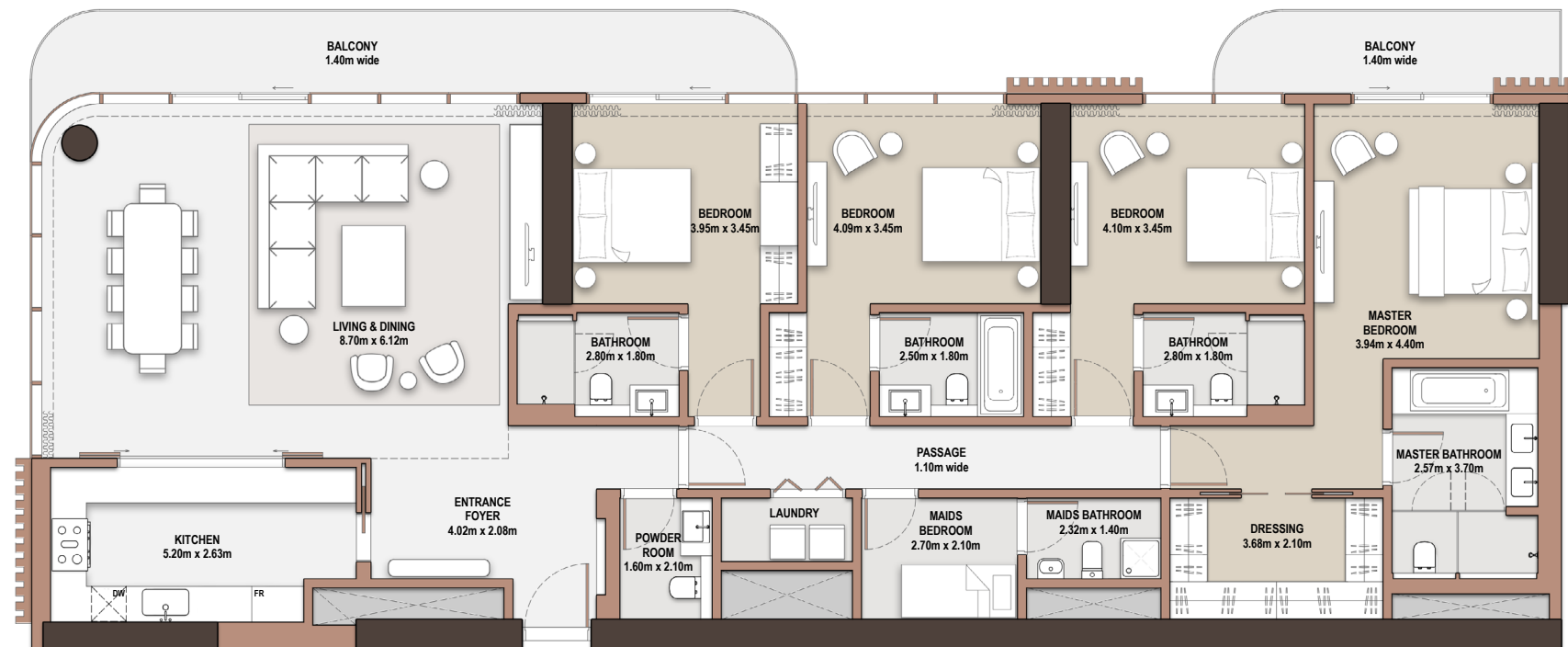

# 4-Bedroom

- *Type* A-4B-C.1

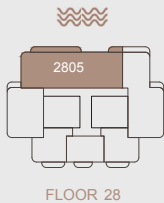

Unit Number			
2805			
Unit Type		Suite Area N/A	SQM   SQFT
A-4B-C.1		233.55	2,513.91
Balcony Area	SQM   SQFT	Total Area NSA	SQM   SQFT
23.91	257.36	257.46	2,771.27

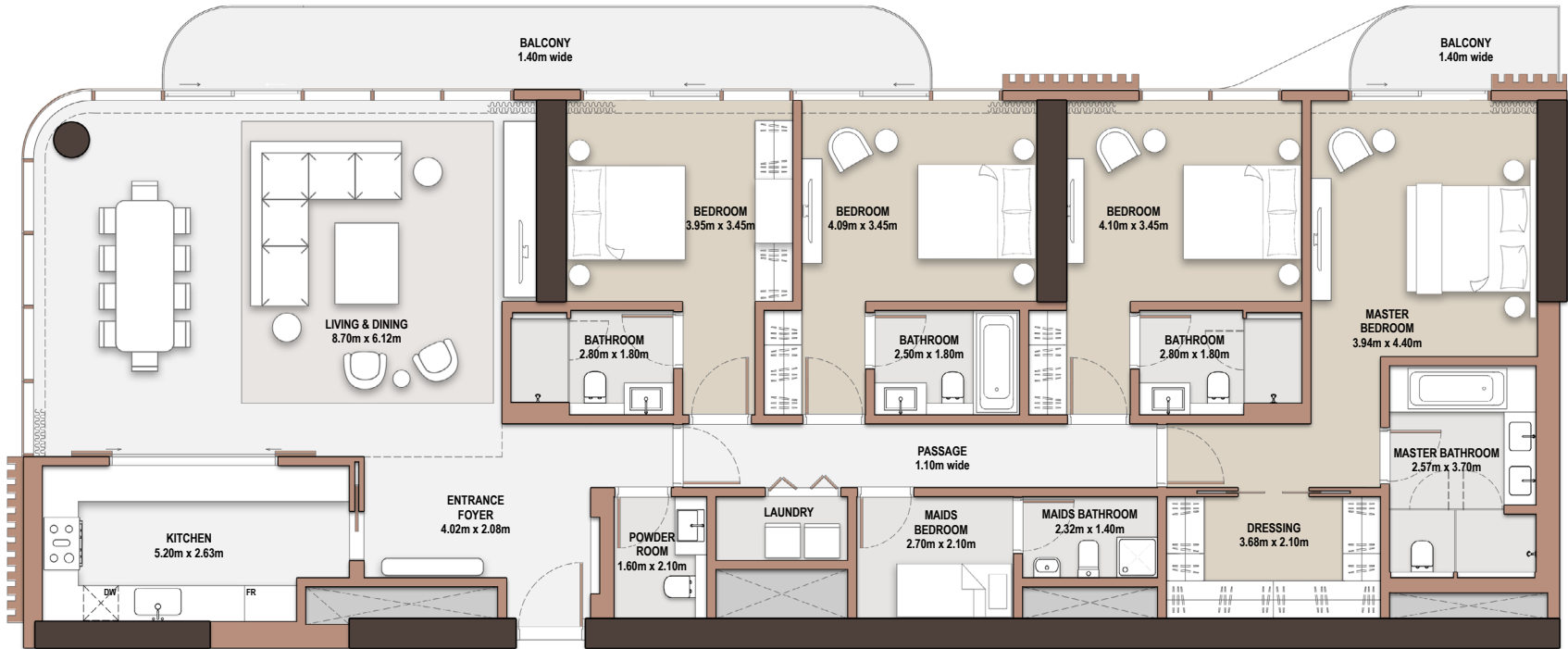



# 5-Bedroom Penthouse

- *Type* A-PH-A

Unit Number			
3001			
Unit Type	Suite Area N/A		
A-PH-A	452.90   4,874.97		
Balcony Area	Total Area NSA		
420.29   4,523.96	873.19   9,398.93		

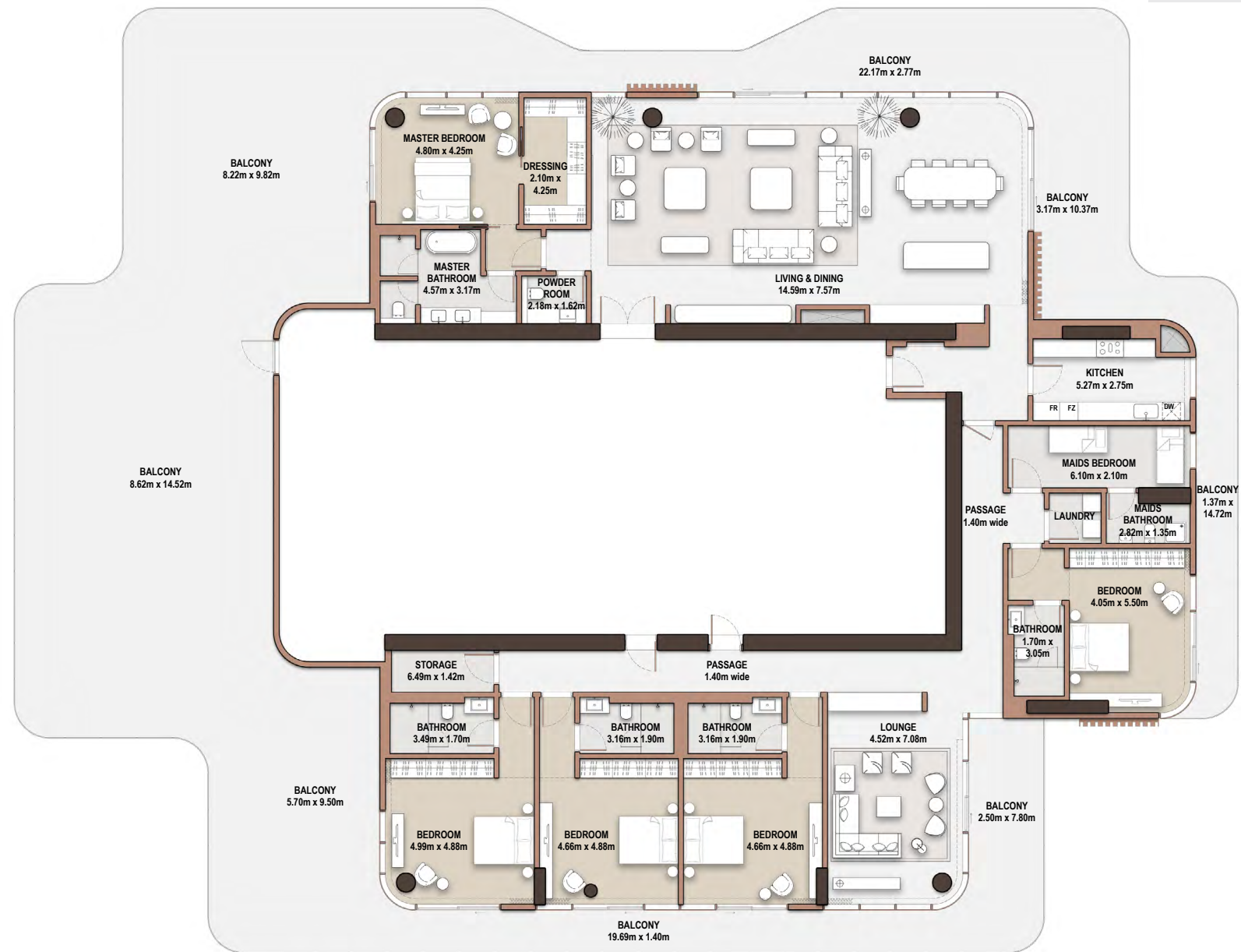





Tower



B



# 1-Bedroom

- Type B-1B-A.1

Unit Number 202, 402, 602, 802, 1002, 1202, 1402, 1602, 1802, 2202, 2402, 2602, 2802, 3002, 3202, 3402			
Unit Type B-1B-A.1	Suite Area NIA 70.91	SQM   SQFT   763.27	
Balcony Area 10.25	SQM   SQFT   110.33	Total Area NSA 81.16	SQM   SQFT   873.60

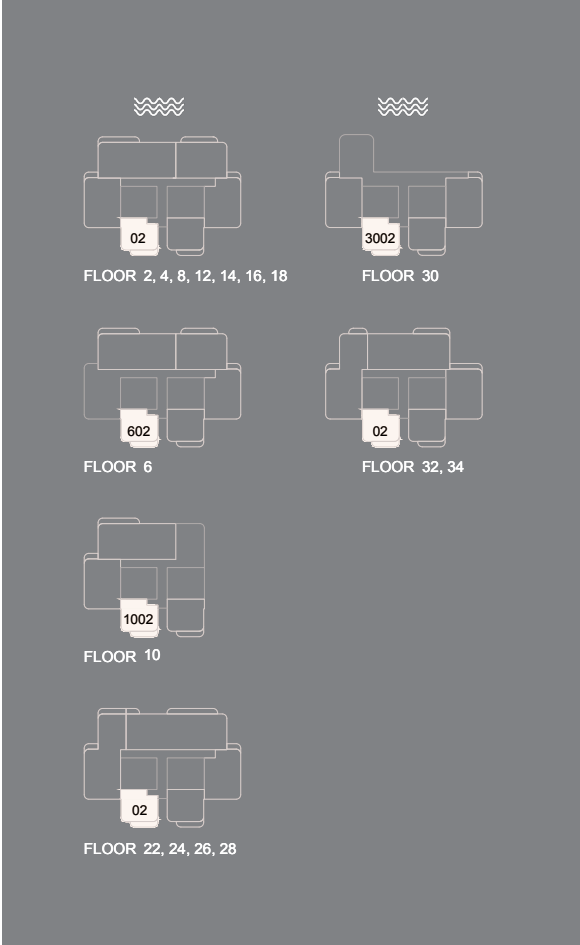
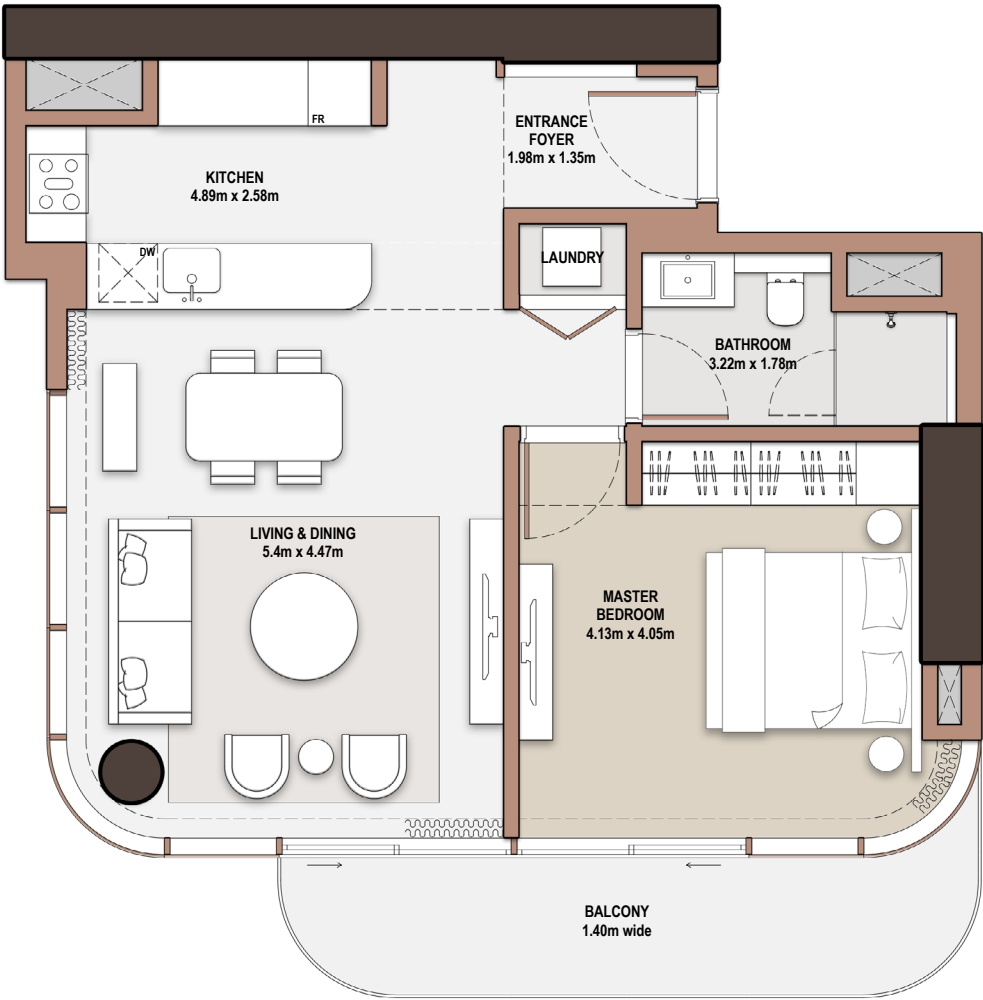

# 1-Bedroom

- Type B-1B-A.2

Unit Number			
102, 302, 502, 702, 902, 1102, 1302, 1502, 1702, 1902, 2302, 2502, 2702, 2902, 3102, 3302, 3502			
Unit Type	Suite Area NIA SQM   SQFT		
B-1B-A.2	70.90   763.16		
Balcony Area SQM   SQFT	Total Area NSA SQM   SQFT		
10.25   110.33	81.15   873.49		

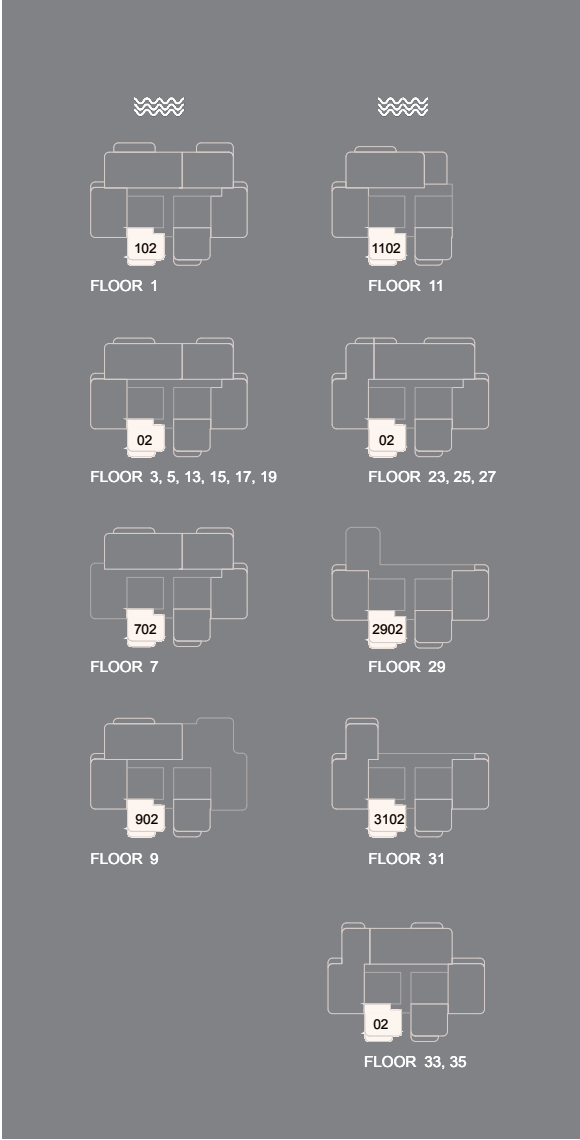
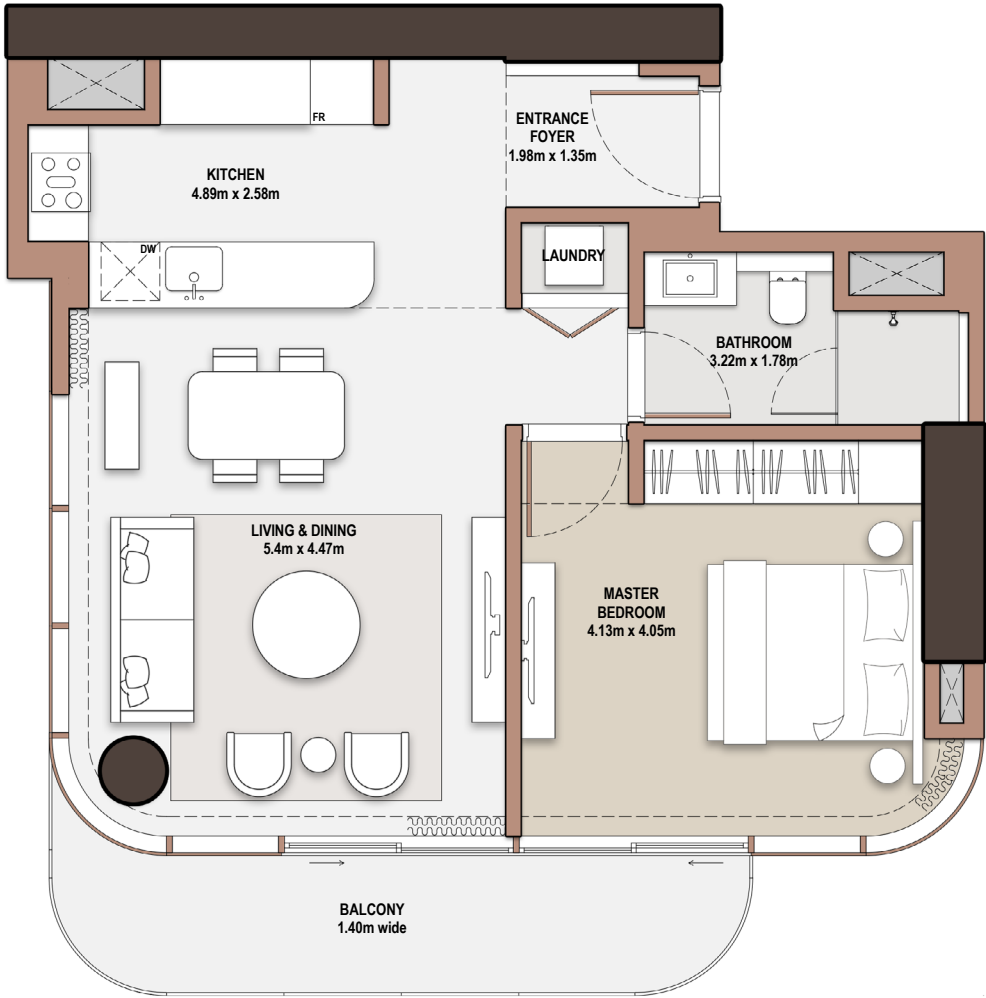

# 1-Bedroom

- Type B-1B-B.1

Unit Number			
201, 401, 601, 801, 1001, 1201, 1401, 1601, 1801, 2201, 2401, 2601, 2801, 3001, 3201, 3401			
Unit Type	Suite Area NIA SQM   SQFT		
B-1B-B.1	77.05   829.36		
Balcony Area SQM   SQFT	Total Area NSA SQM   SQFT		
10.21   109.90	87.26   939.26		

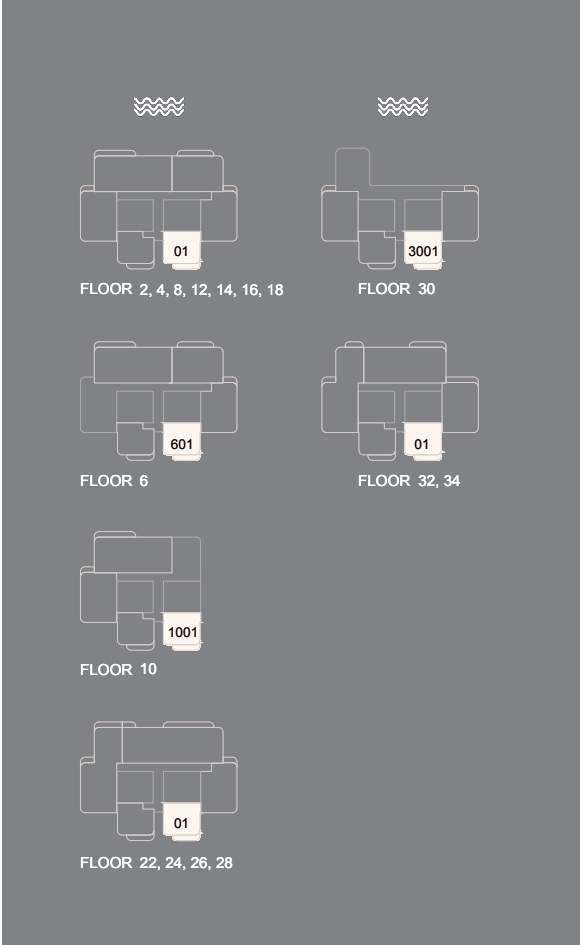
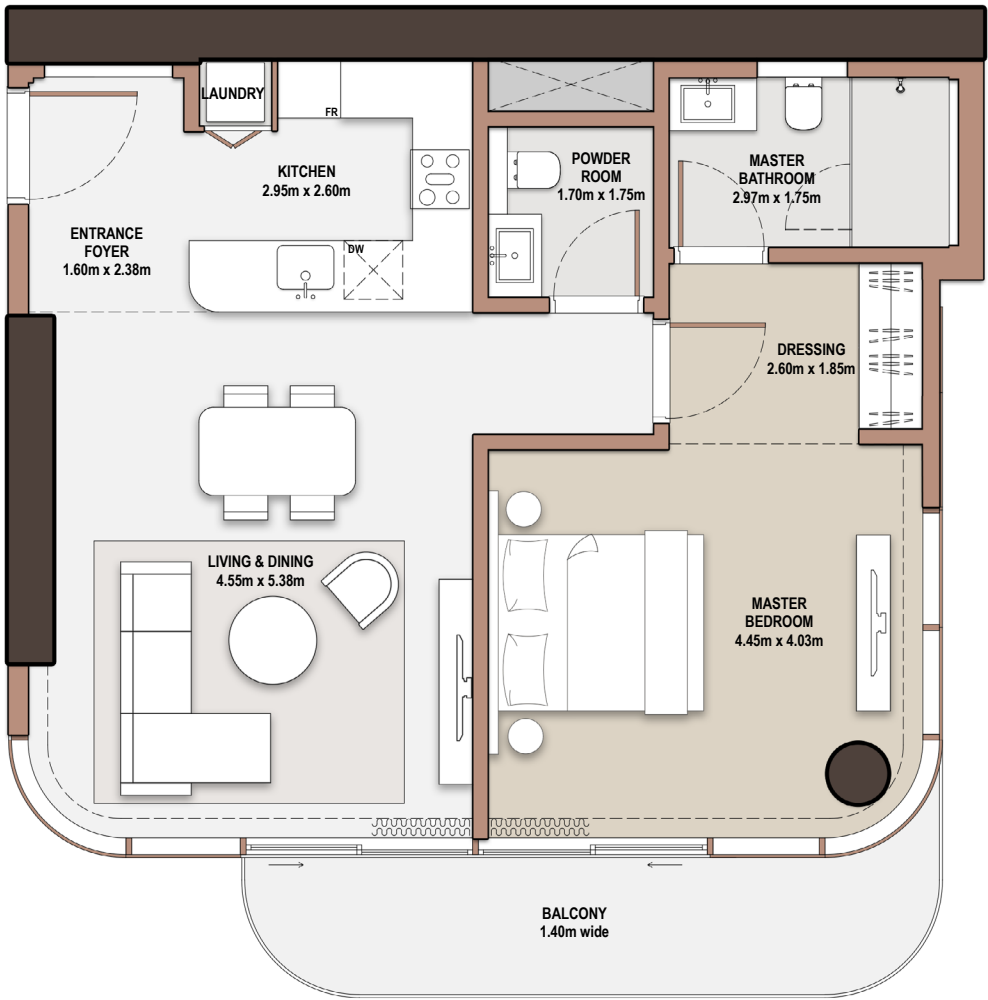

# 1-Bedroom

- Type B-1B-B.2

Unit Number			
101, 301, 501, 701, 901, 1101, 1301, 1501, 1701, 1901, 2301, 2501, 2701, 2901, 3101, 3301, 3501			
Unit Type	Suite Area NIA SQM   SQFT		
B-1B-B.2	77.05   829.36		
Balcony Area SQM   SQFT	Total Area NSA SQM   SQFT		
10.25   110.33	87.30   939.69		

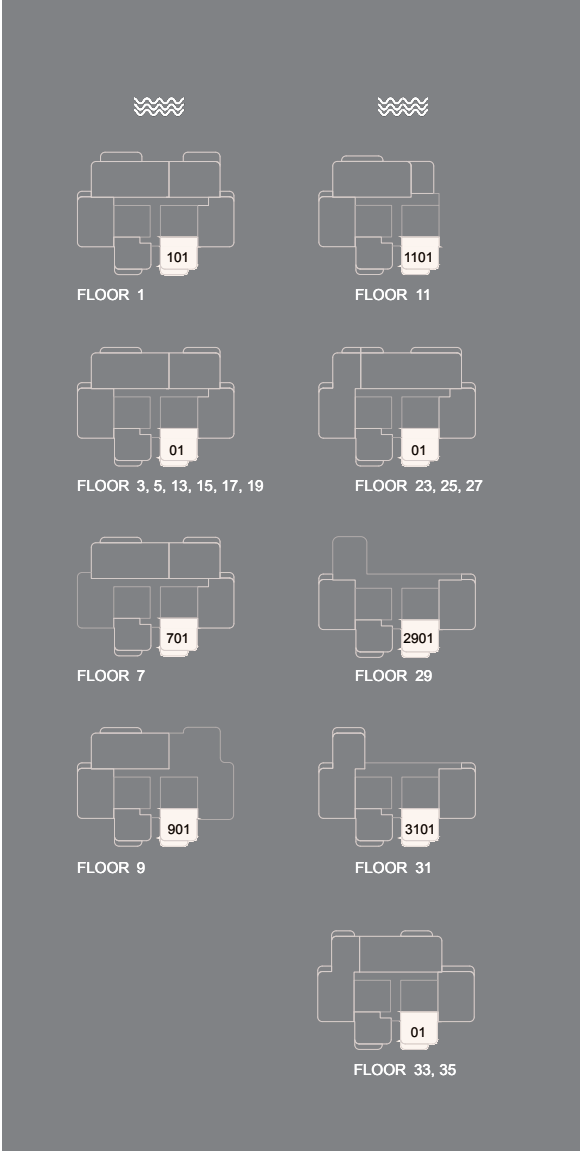
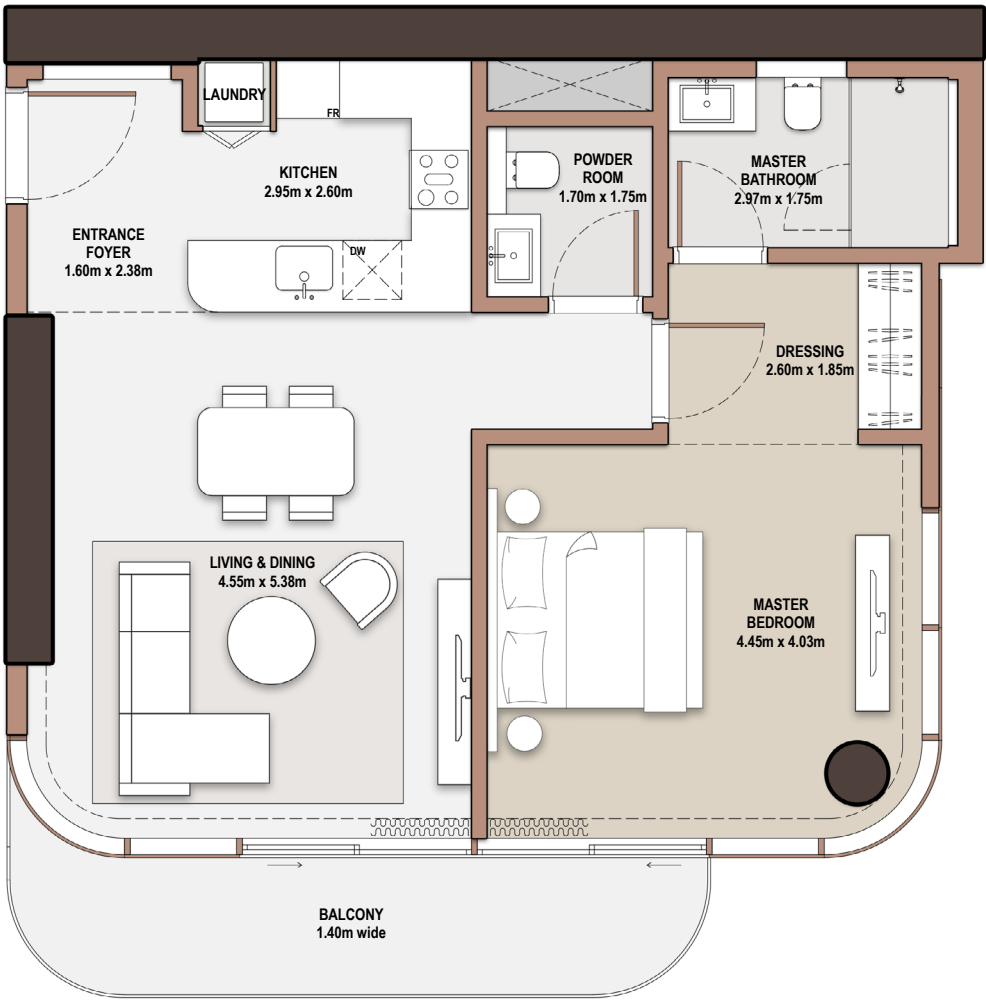

# 2-Bedroom

- Type B-2B-A.1

Unit Number			
106, 206, 306, 406, 506, 605, 705, 806, 1206, 1306, 1406, 1506, 1606, 1706, 1806, 1906			
Unit Type	Suite Area NIA SQM   SQFT		
B-2B-A.1	112.24   1,208.14		
Balcony Area	SQM   SQFT	Total Area NSA	SQM   SQFT
5.49   59.09		117.73   1,267.23	

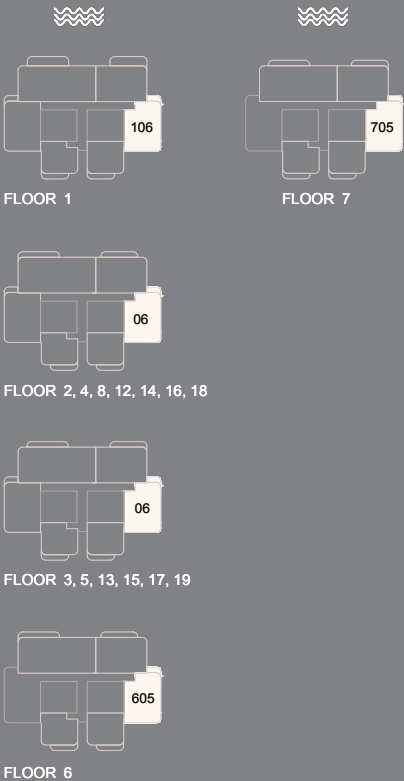
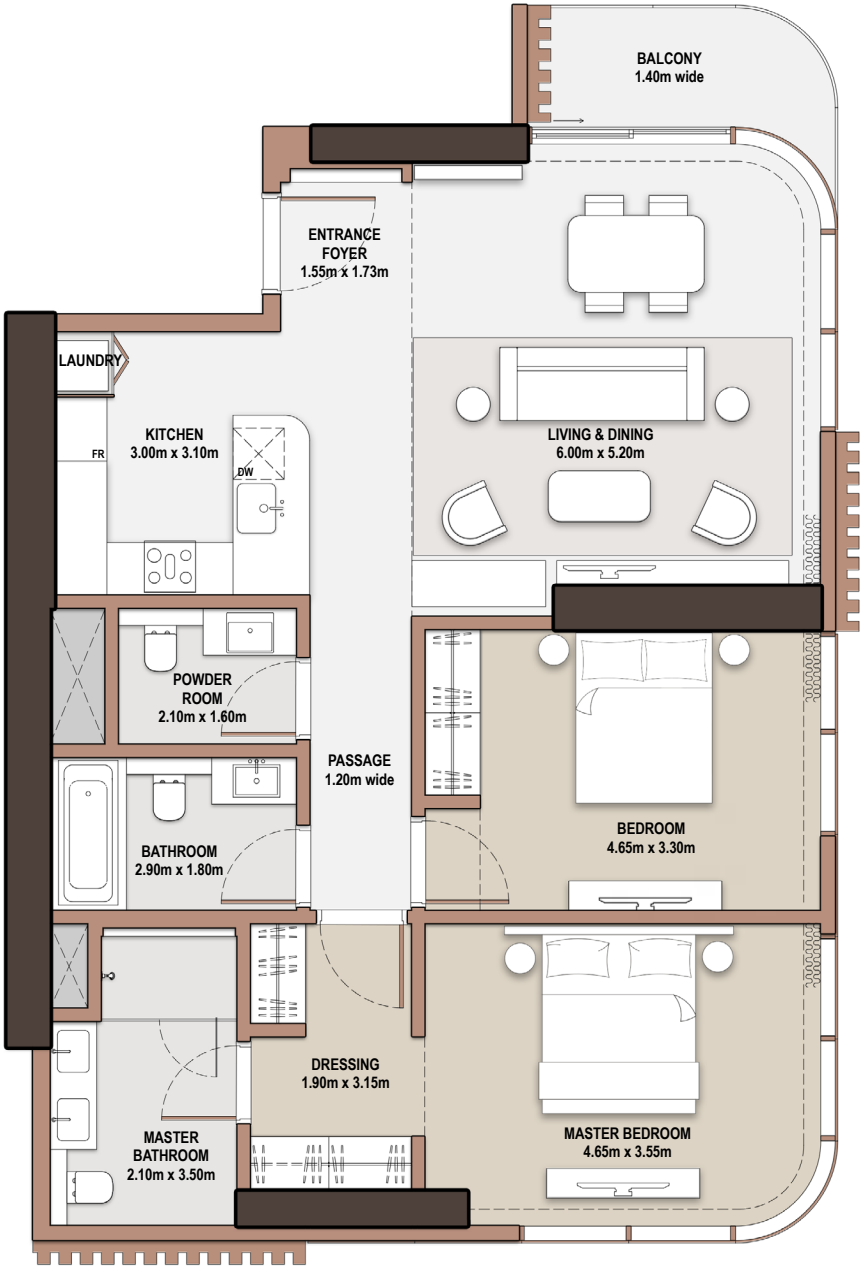

# 2-Bedroom

- Type B-2B-B.1

Unit Number			
103, 203, 303, 403, 503, 803, 903, 1003, 1103, 1203, 1303, 1403, 1503, 1603, 1703, 1803, 1903, 2101, 2903, 3003			
Unit Type	Suite Area NIA      SQM   SQFT		
B-2B-B.1	118.21   1,272.40		
Balcony Area	SQM   SQFT	Total Area NSA	SQM   SQFT
5.48   58.99		123.69   1,331.39	

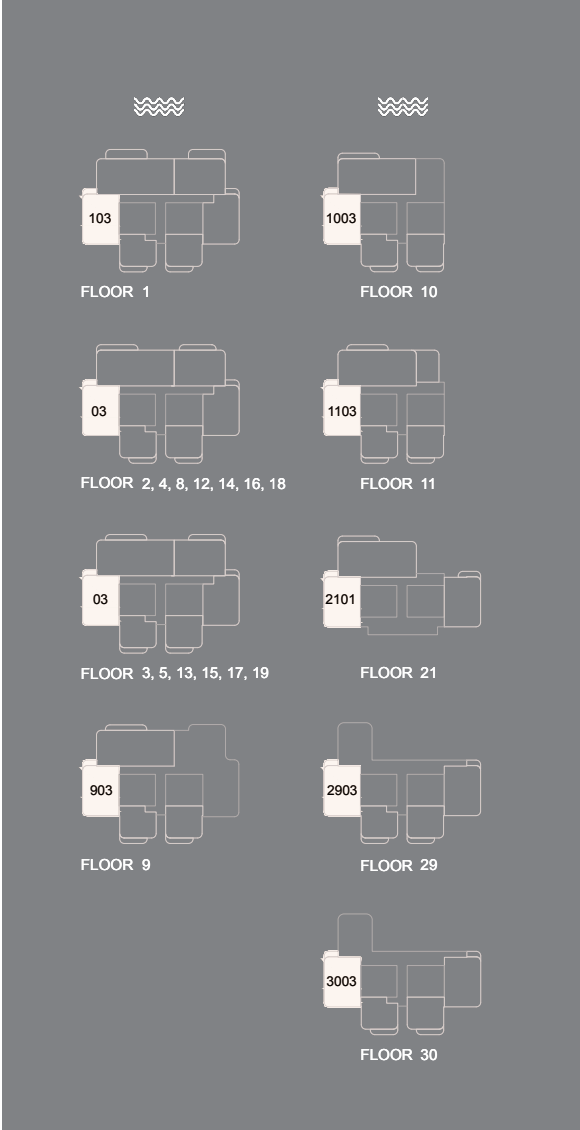
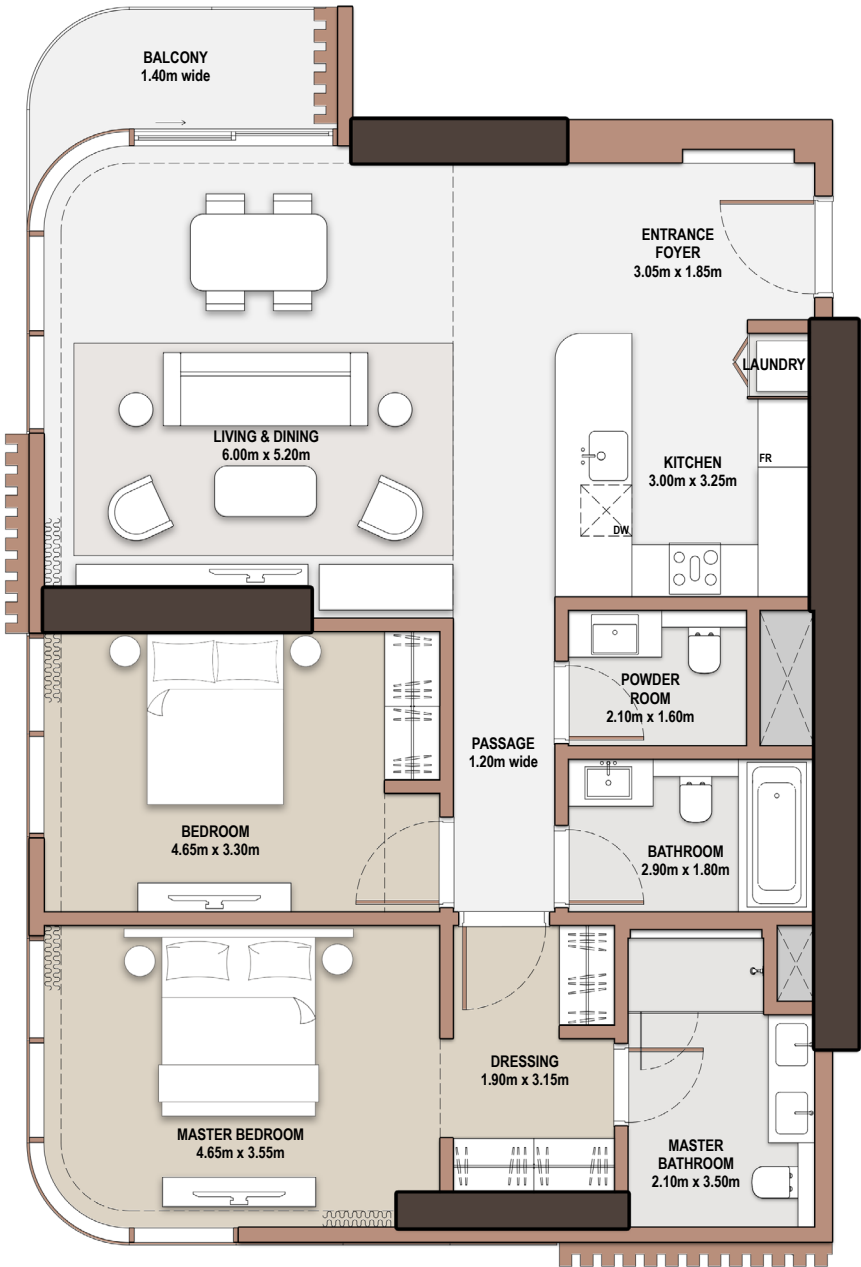



# 2-Bedroom

- Type B-2B-C.1

Unit Number			
2103			
Unit Type		Suite Area NIA	SQM   SQFT
B-2B-C.1		118.99	1,280.80
Balcony Area	SQM   SQFT	Total Area NSA	SQM   SQFT
9.13	98.27	128.12	1,379.07

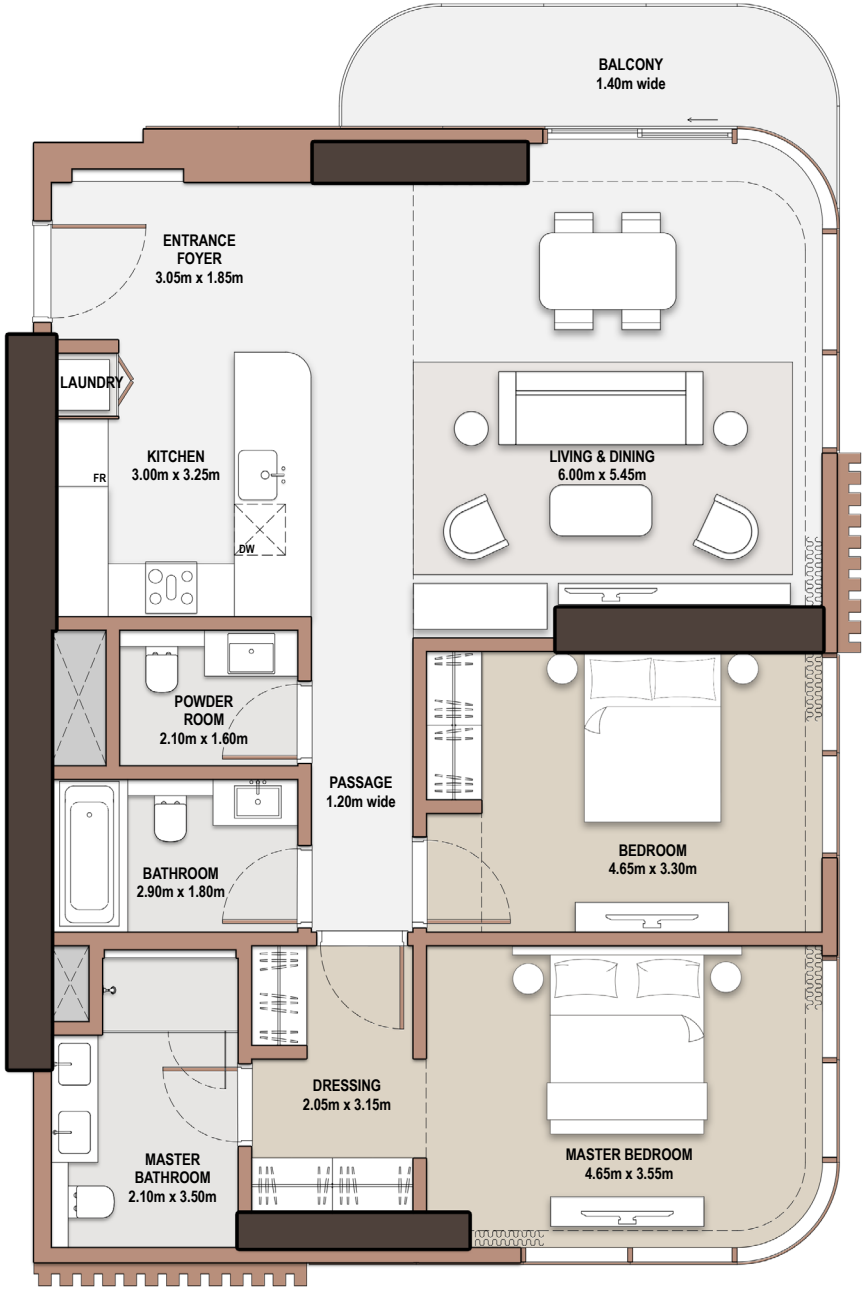

# 2-Bedroom

- *Type* B-2B-C.2

Unit Number			
3205			
Unit Type		Suite Area NIA      SQM   SQFT	
B-2B-C.2		118.97   1,280.58	
Balcony Area	SQM   SQFT	Total Area NSA	SQM   SQFT
14.42   155.22		133.39   1,435.80	

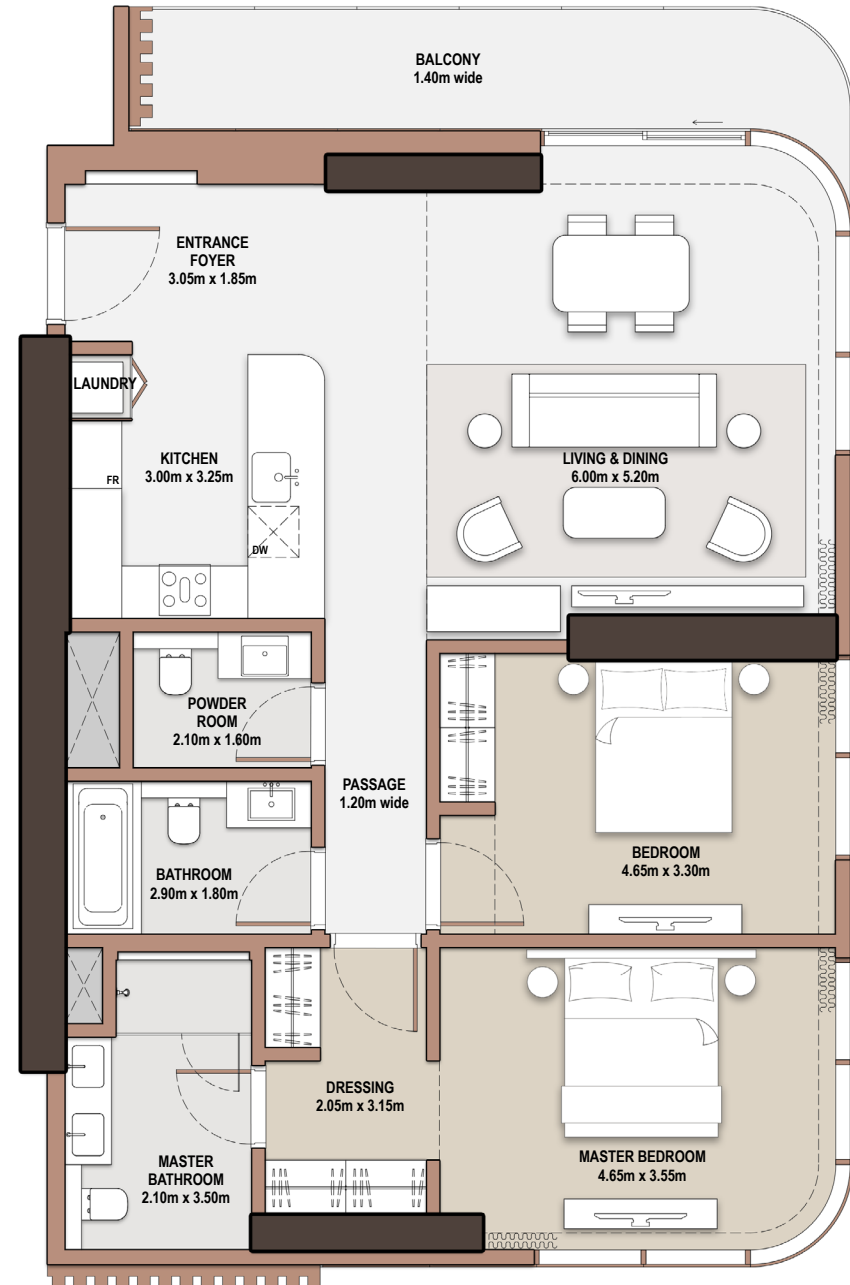

# 2-Bedroom

- Type B-2B-C.3

Unit Number			
3305, 3405, 3505			
Unit Type		Suite Area NIA	SQM   SQFT
B-2B-C.3		118.97	1,280.58
Balcony Area	SQM   SQFT	Total Area NSA	SQM   SQFT
6.98	75.13	125.95	1,355.71

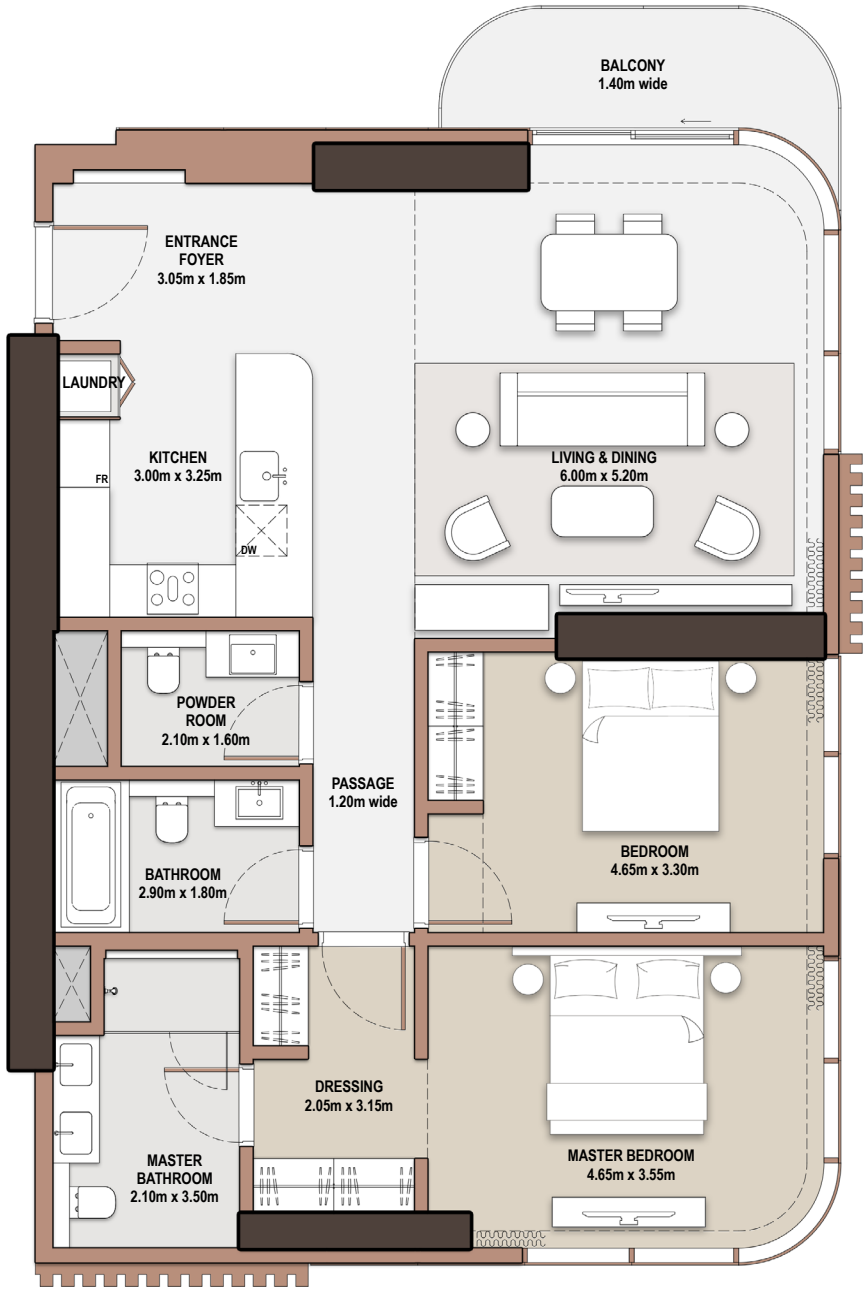

# 2-Bedroom

- Type B-2B-D.1

Unit Number			
2205, 2305, 2405, 2505, 2605, 2705, 2805			
Unit Type		Suite Area NIA      SQM   SQFT	
B-2B-D.1		117.91   1,269.17	
Balcony Area	SQM   SQFT	Total Area NSA	SQM   SQFT
5.49   59.09		123.40   1,328.27	

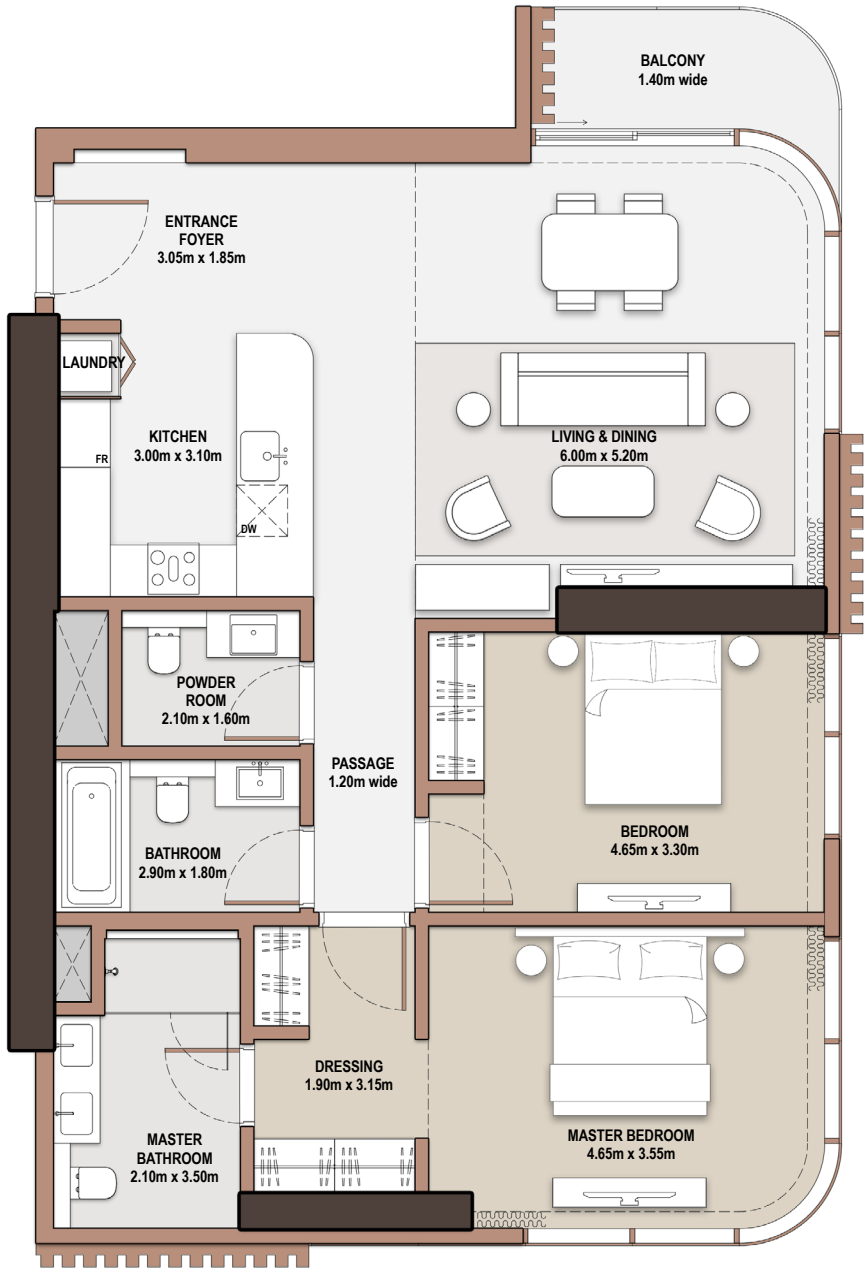

# 2-Bedroom

- *Type* B-2B-D.2

Unit Number			
2904, 3004, 3104			
Unit Type		Suite Area NIA	SQM   SQFT
B-2B-D.2		117.91	1,269.17
Balcony Area	SQM   SQFT	Total Area NSA	SQM   SQFT
5.97	64.26	123.88	1,333.43

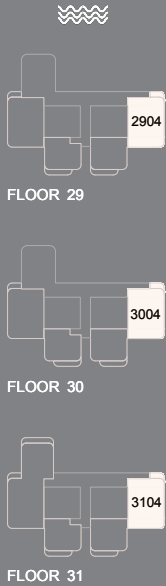
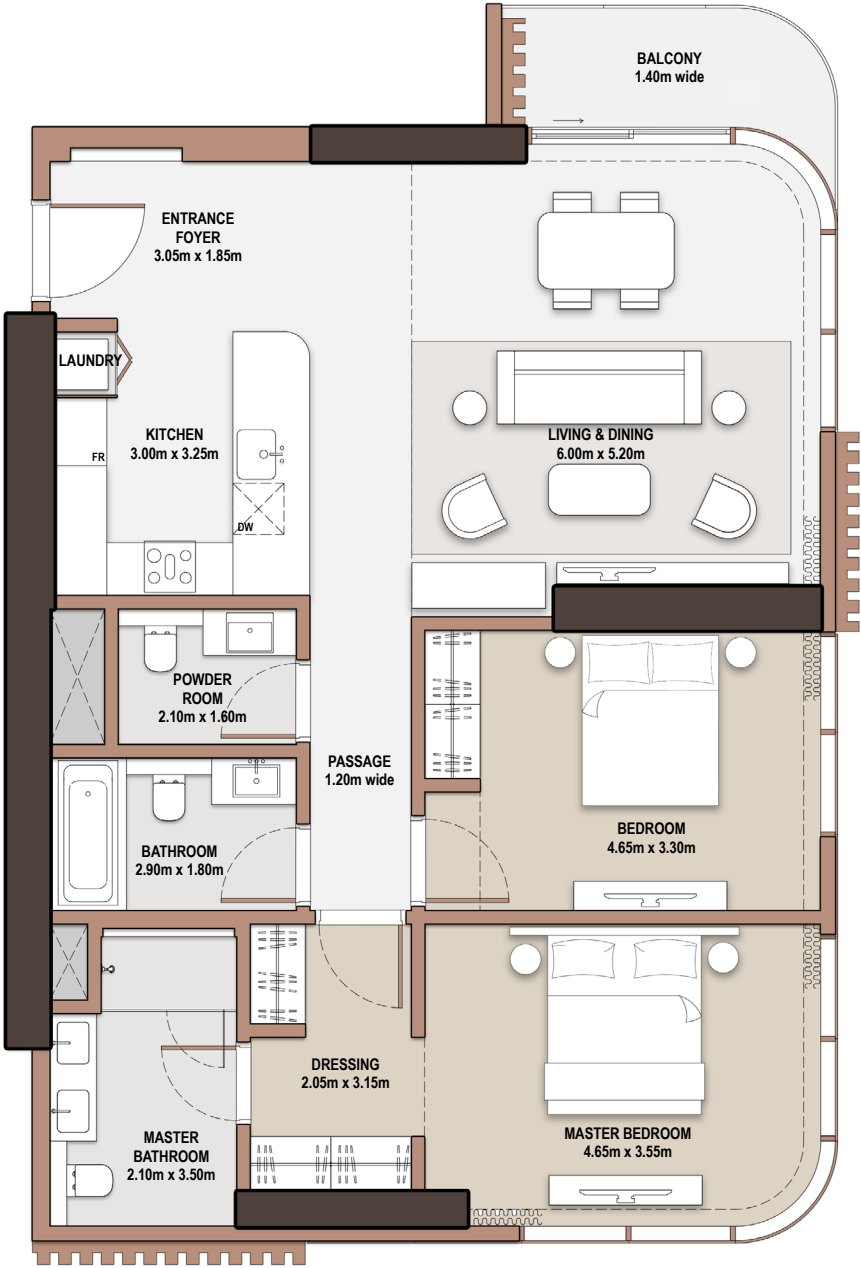

# 2-Bedroom

- *Type* B-2BM-A.1

Unit Number			
205, 405, 604, 805, 1205, 1405, 1605, 1805			
Unit Type		Suite Area NIA	SQM   SQFT
B-2BM-A.1		120.35	1,295.44
Balcony Area	SQM   SQFT	Total Area NSA	SQM   SQFT
13.79	148.43	134.14	1,443.87

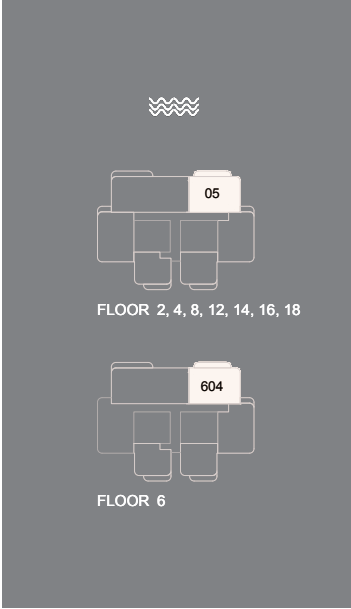
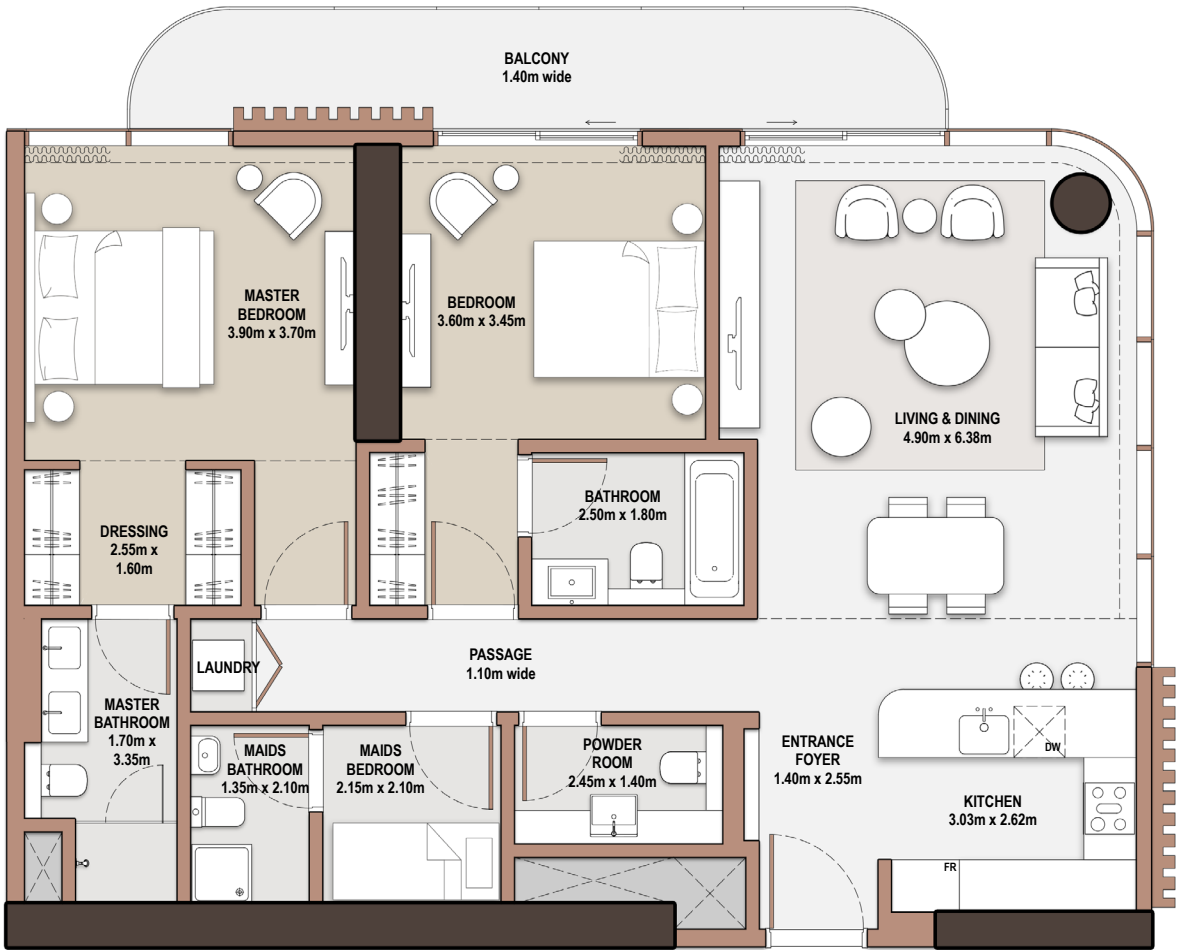

- *Type* B-2BM-A.2

**BALCONY**  
1.40m wide

**MASTER BEDROOM**  
3.90m x 3.70m

**BEDROOM**  
3.60m x 3.45m

**LIVING & DINING**  
4.90m x 6.38m

**BATHROOM**  
2.50m x 1.80m

**DRESSING**  
2.55m x 1.60m

**PASSAGE**  
1.10m wide

**MASTER BATHROOM**  
1.70m x 3.35m

**LAUNDRY**

**MAIDS BATHROOM**  
1.35m x 2.10m

**MAIDS BEDROOM**  
2.15m x 2.10m

**POWDER ROOM**  
2.45m x 1.40m

**ENTRANCE FOYER**  
1.40m x 2.55m

**KITCHEN**  
3.03m x 2.62m

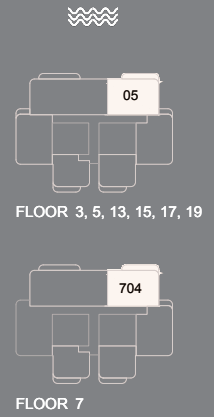



# 2-Bedroom

- *Type* B-2BM-A.3

Unit Number			
105			
Unit Type		Suite Area NIA	
B-2BM-A.3		SQM   SQFT	
		120.35   1,295.44	
Balcony Area		Total Area NSA	
SQM   SQFT		SQM   SQFT	
23.59   253.92		143.94   1,549.36	

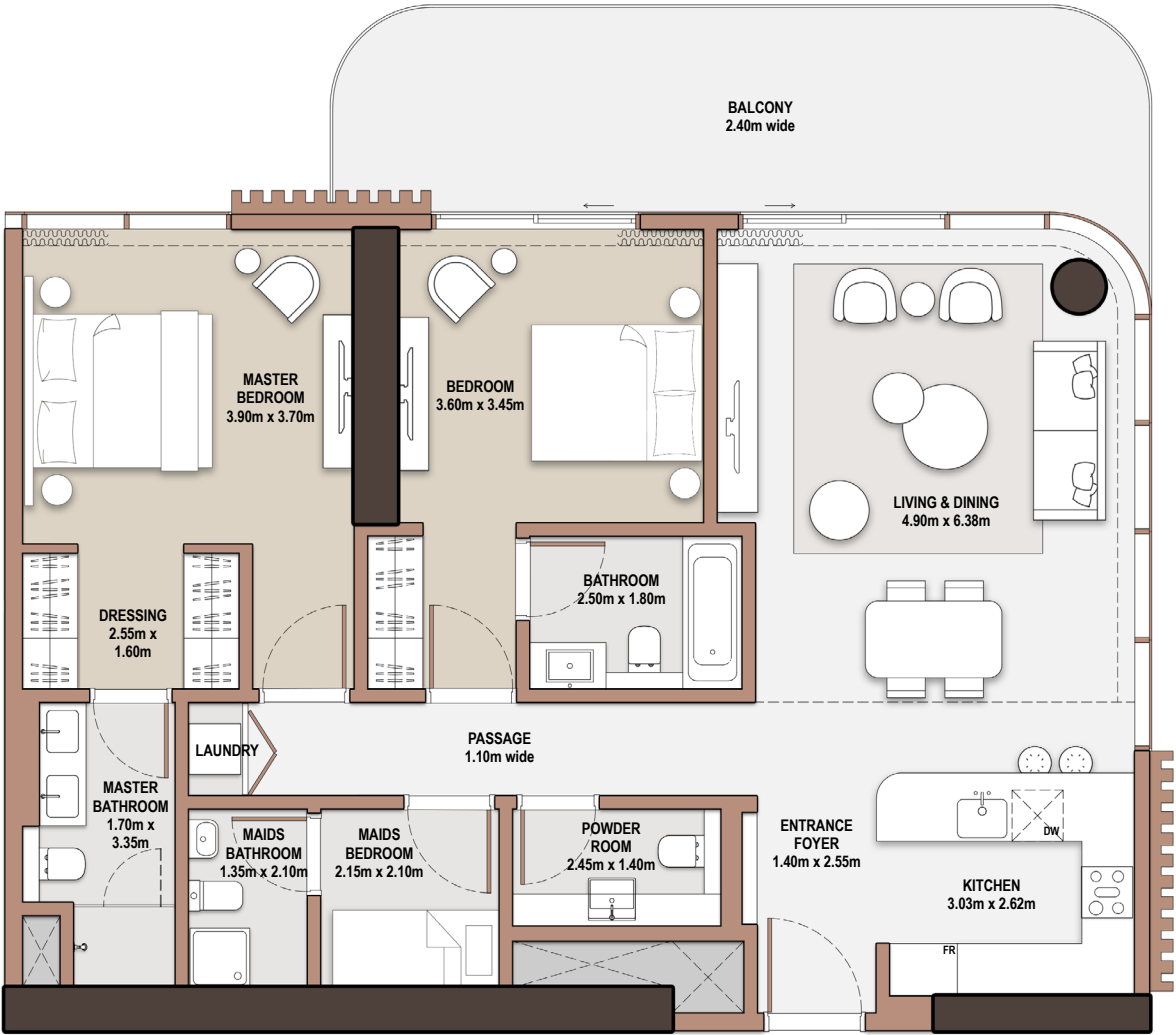

# 3-Bedroom

- Type B-3B-A.1

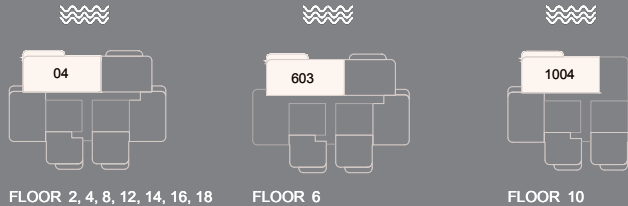

Unit Number			
204, 404, 603, 804, 1004, 1204, 1404, 1604, 1804			
Unit Type	Suite Area NIA SQM   SQFT		
B-3B-A.1	184.27   1,983.46		
Balcony Area SQM   SQFT	Total Area NSA SQM   SQFT		
15.71   169.10	199.98   2,152.56		

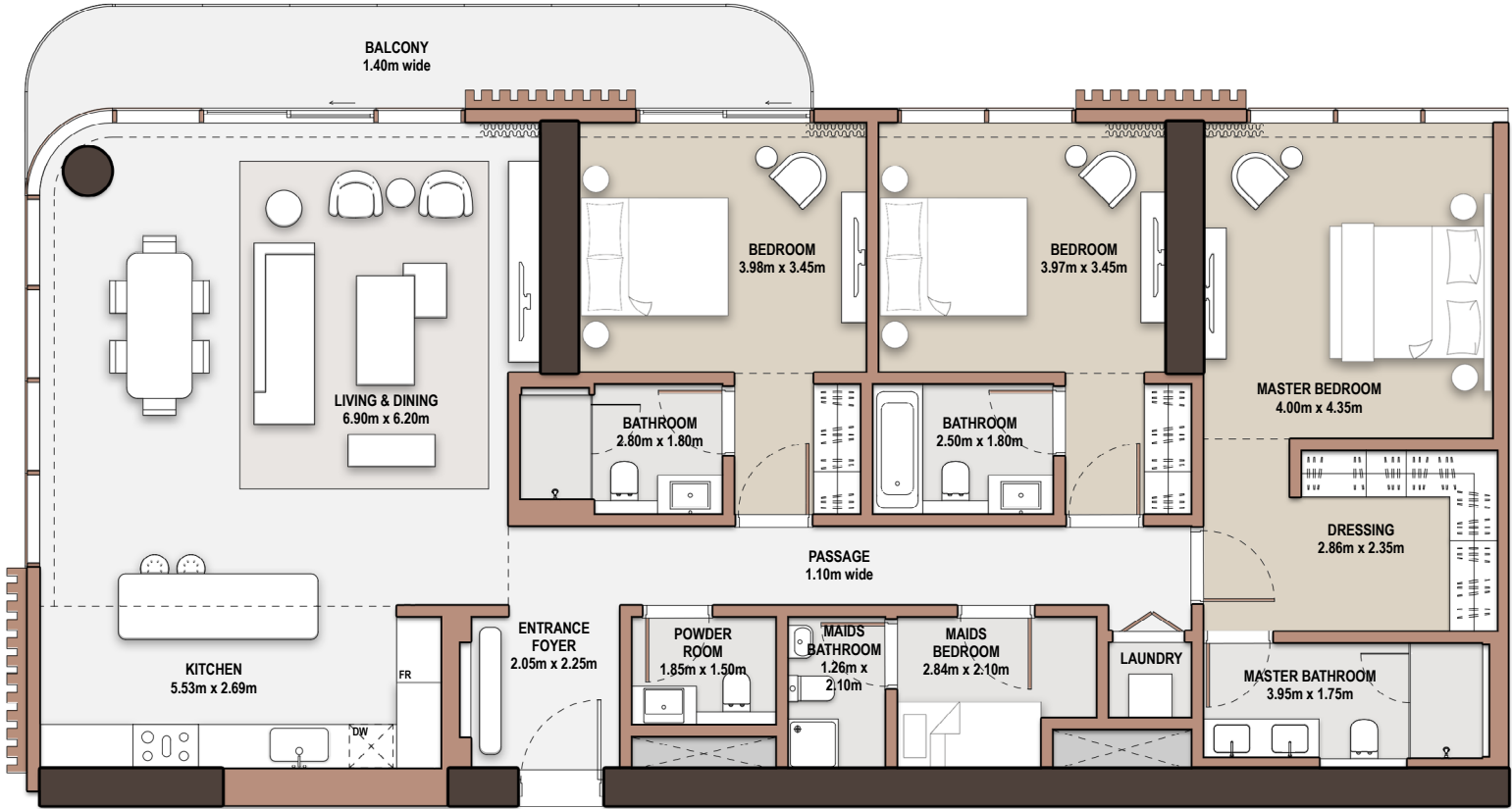

# 3-Bedroom

- *Type* B-3B-A.2



Unit Number		304, 504, 703, 904, 1304, 1504, 1704, 1904	
Unit Type	Suite Area NIA	SQM   SQFT	
B-3B-A.2	184.27		1,983.46
Balcony Area	Total Area NSA	SQM   SQFT	
15.51   166.95	199.78		2,150.41

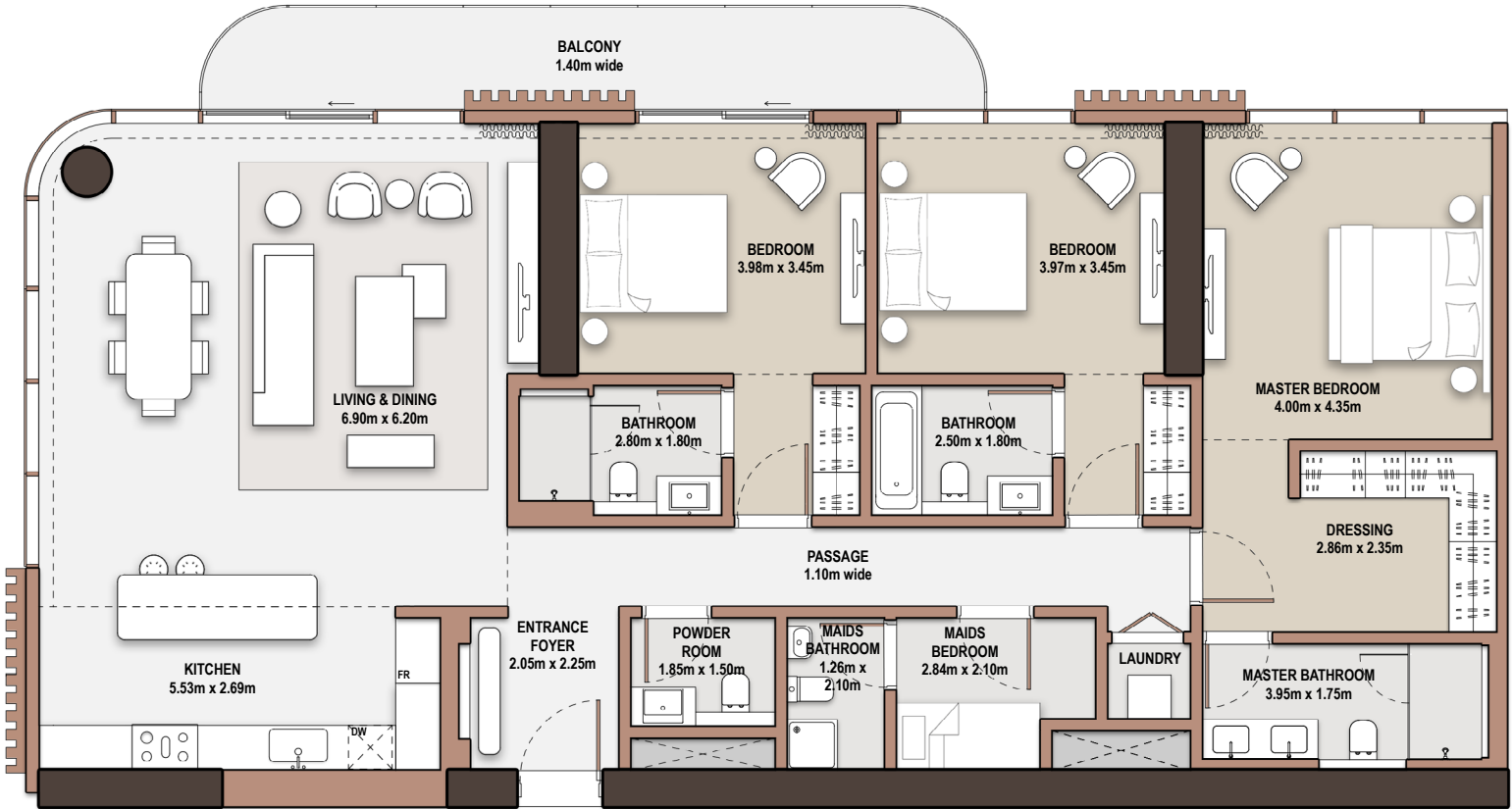

# 3-Bedroom

- Type B-3B-A.3

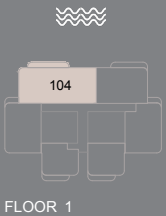

Unit Number			
104			
Unit Type		Suite Area NIA	SQM   SQFT
B-3B-A.3		184.27	1,983.46
Balcony Area	SQM   SQFT	Total Area NSA	SQM   SQFT
26.31	283.20	210.58	2,266.66

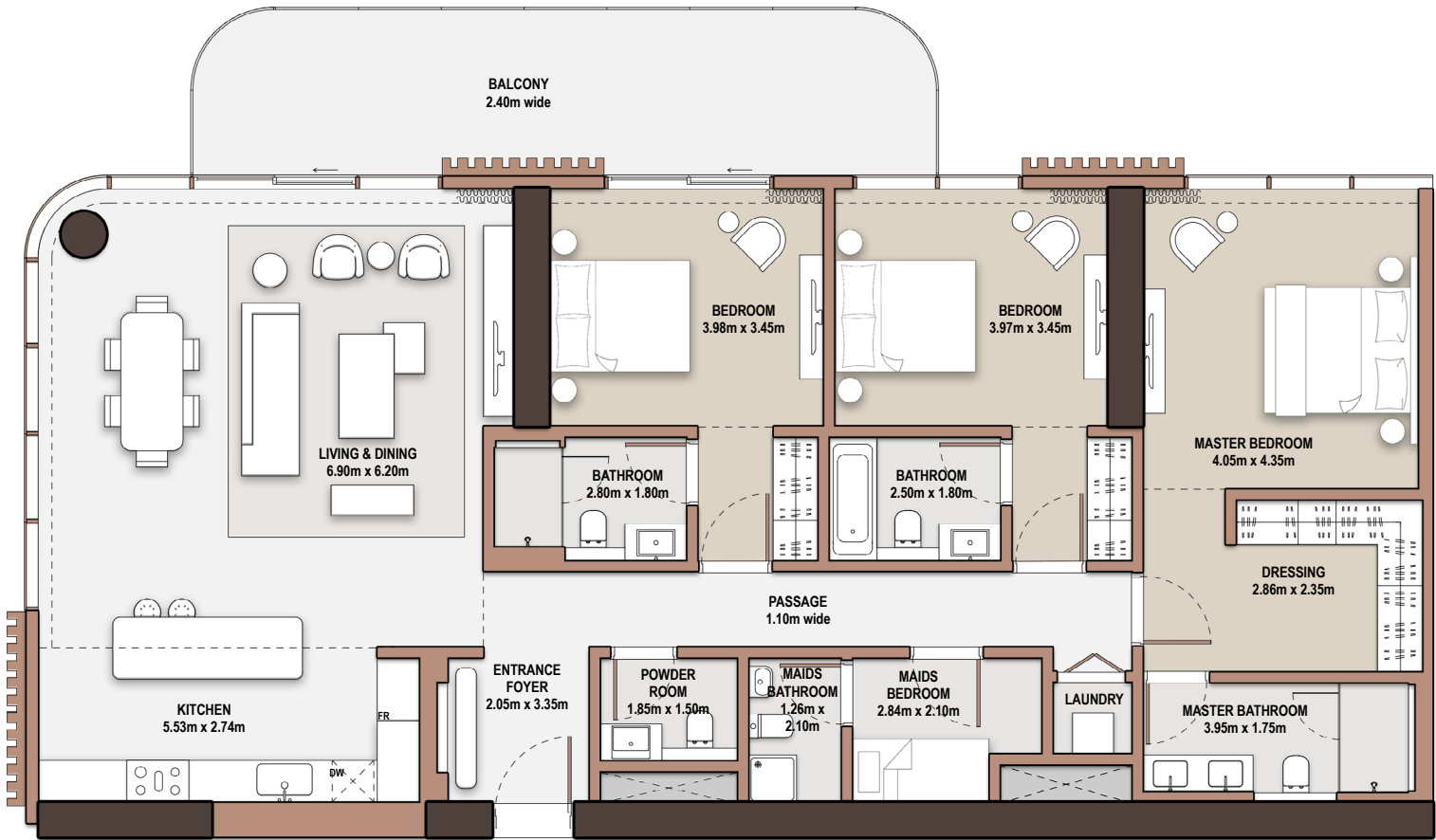

# 3-Bedroom

- Type B-3B-B.1



Unit Number		1104	
Unit Type	Suite Area NIA	SQM   SQFT	
B-3B-B.1	186.46	2,007.04	
Balcony Area	Total Area NSA	SQM   SQFT	
64.13   690.29	250.59	2,697.33	

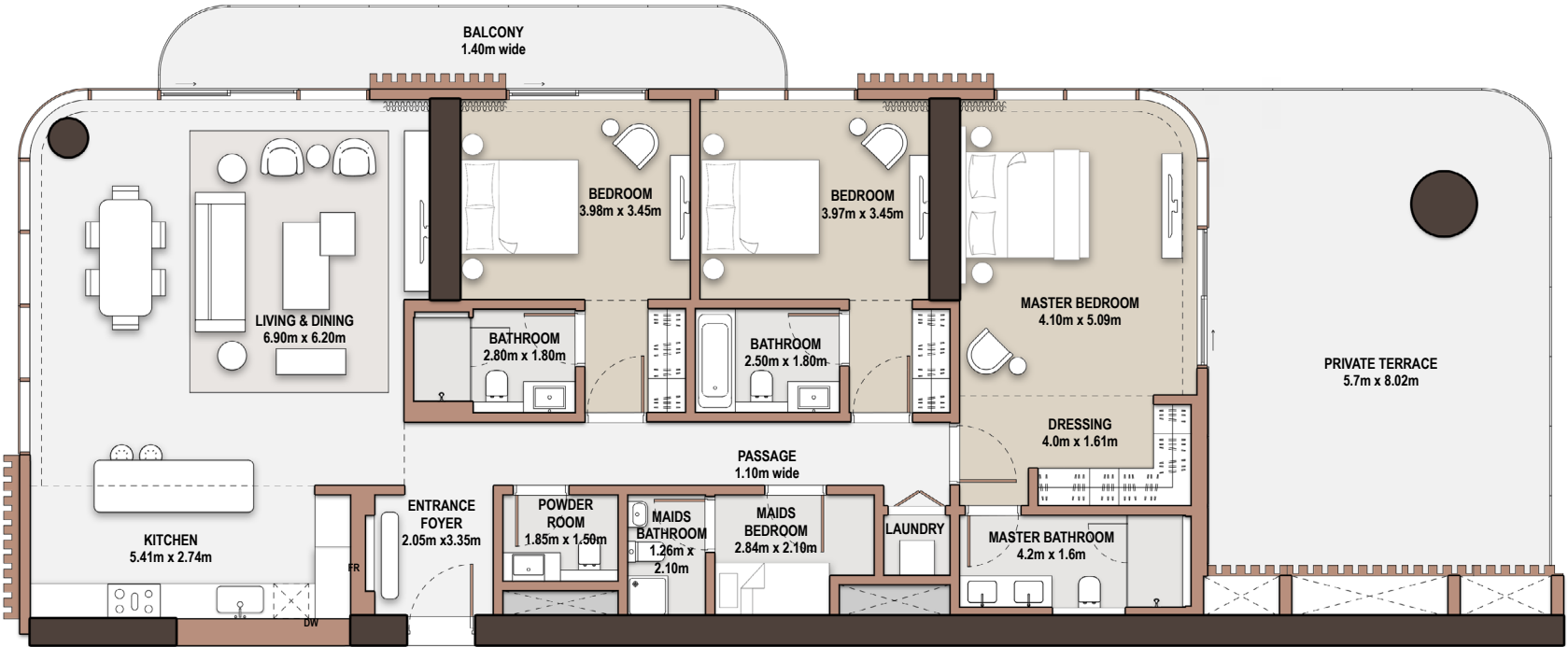

# 3-Bedroom

- Type B-3B-C.1

Unit Number			
2203, 2403, 2603, 2803			
Unit Type		Suite Area NIA	SQM   SQFT
B-3B-C.1		185.36	1,995.20
Balcony Area	SQM   SQFT	Total Area NSA	SQM   SQFT
16.08	173.08	201.44	2,168.28

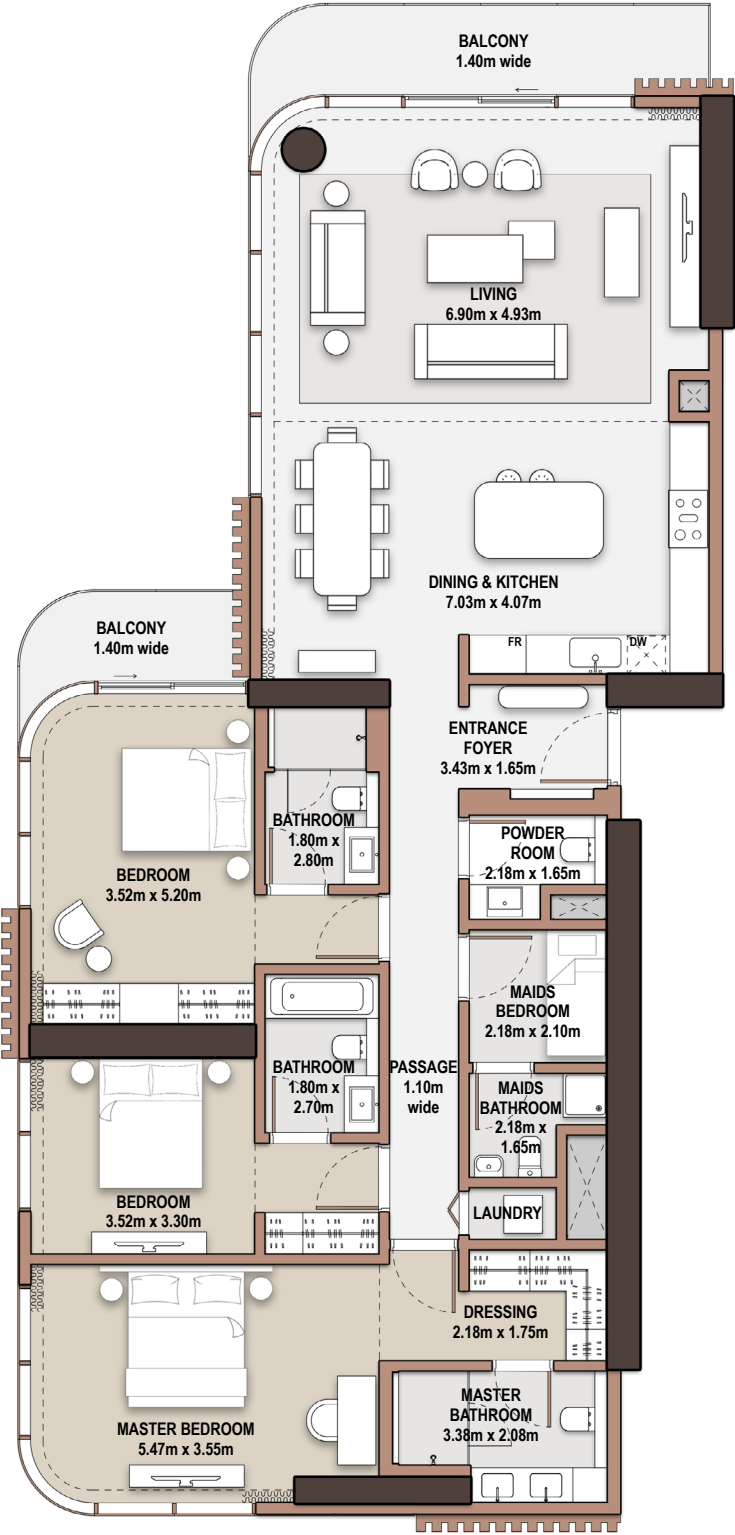



# 3-Bedroom

- *Type* B-3B-C.2

Unit Number			
2303, 2503, 2703			
Unit Type		Suite Area NIA	
B-3B-C.2		185.37   1,995.30	
Balcony Area		Total Area NSA	
12.33   132.72		197.70   2,128.02	

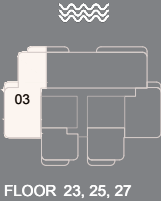
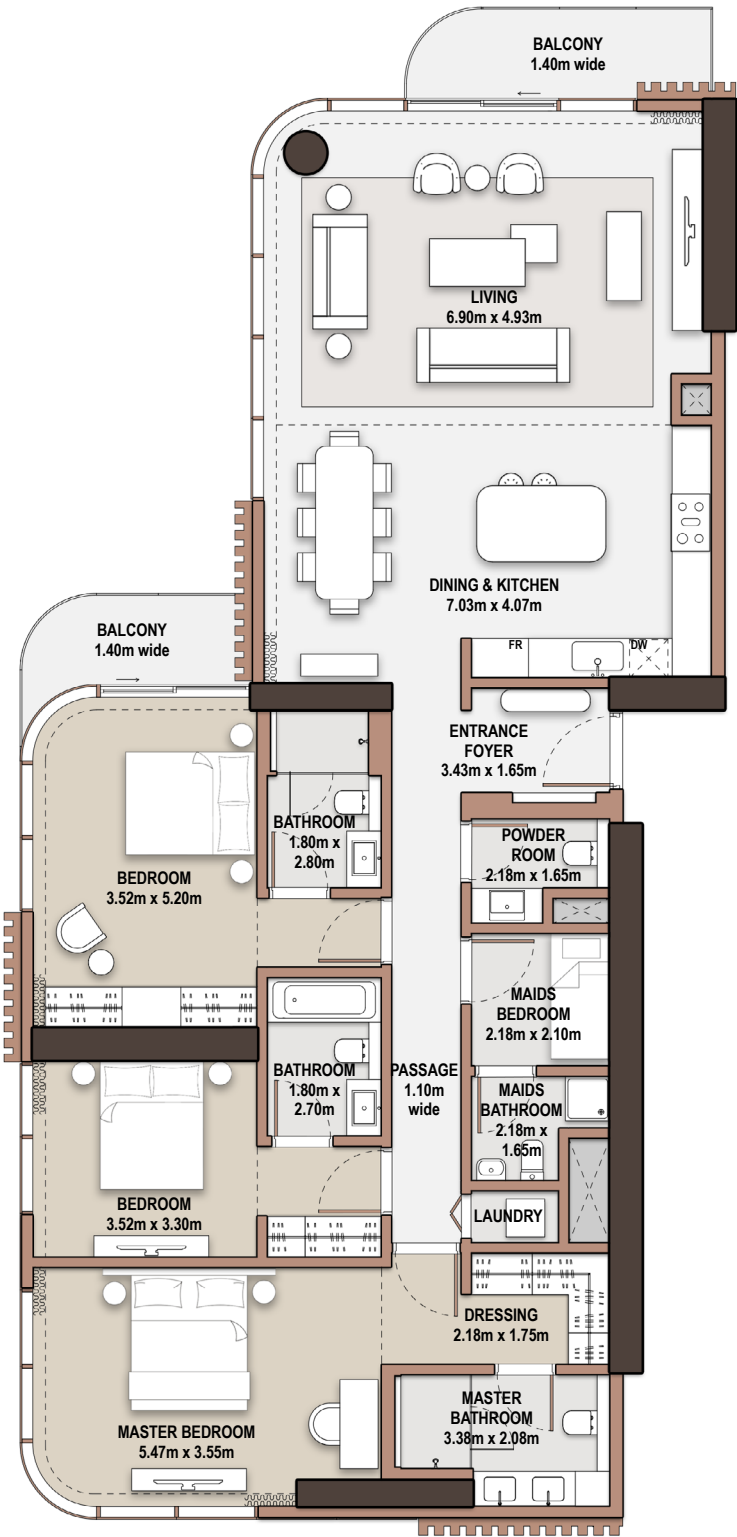

# 3-Bedroom

- *Type* B-3B-D.1

Unit Number			
3203, 3403			
Unit Type		Suite Area NIA	SQM   SQFT
B-3B-D.1		185.27	1,994.23
Balcony Area	SQM   SQFT	Total Area NSA	SQM   SQFT
12.00	129.17	197.27	2,123.39

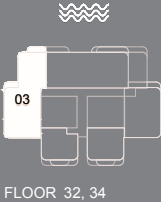
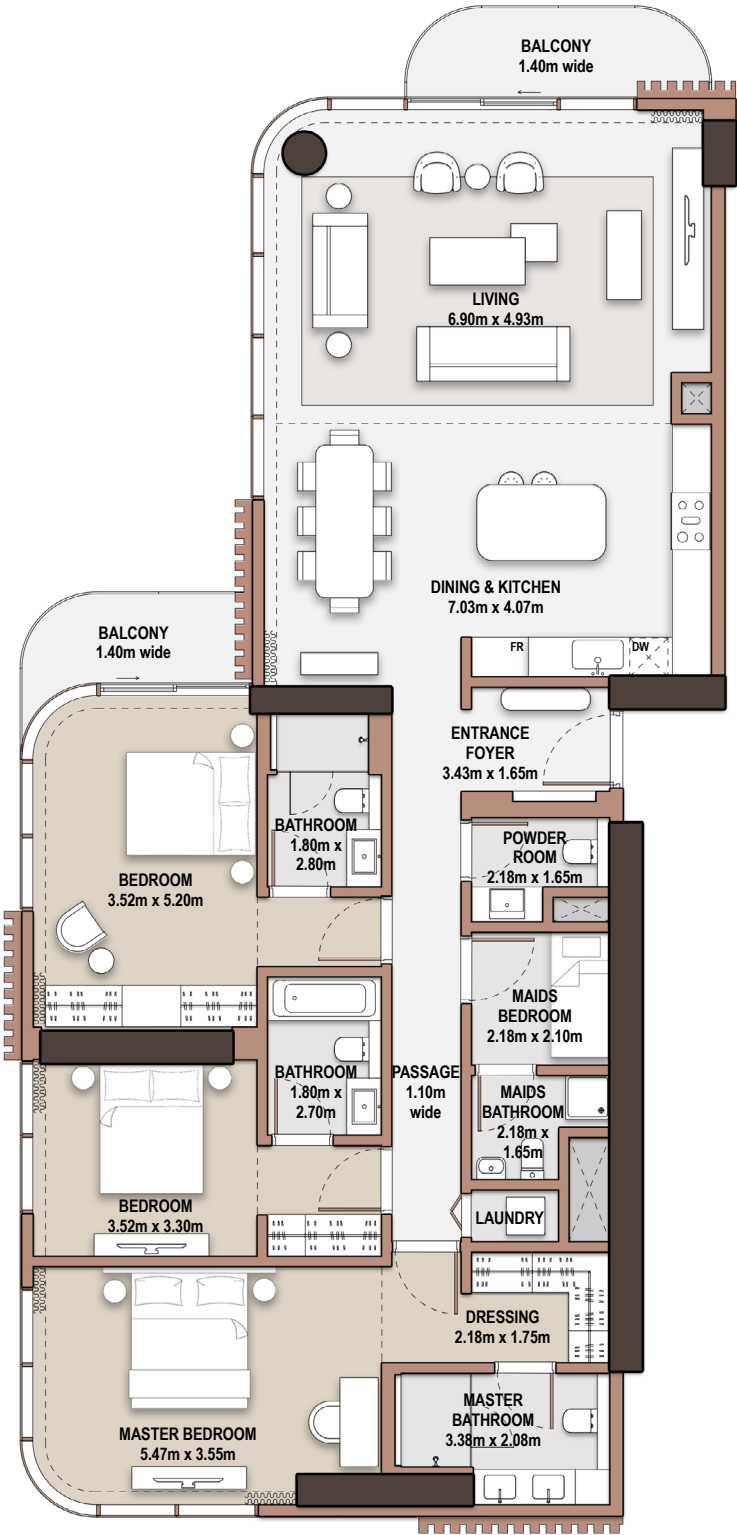

# 3-Bedroom

- *Type* B-3B-D.2

Unit Number			
3303, 3503			
Unit Type	Suite Area NIA SQM   SQFT		
B-3B-D.2	185.28   1,994.34		
Balcony Area SQM   SQFT	Total Area NSA	SQM   SQFT	
13.91   149.73	199.19	2,144.06	

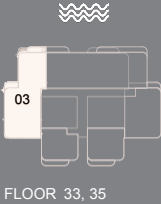
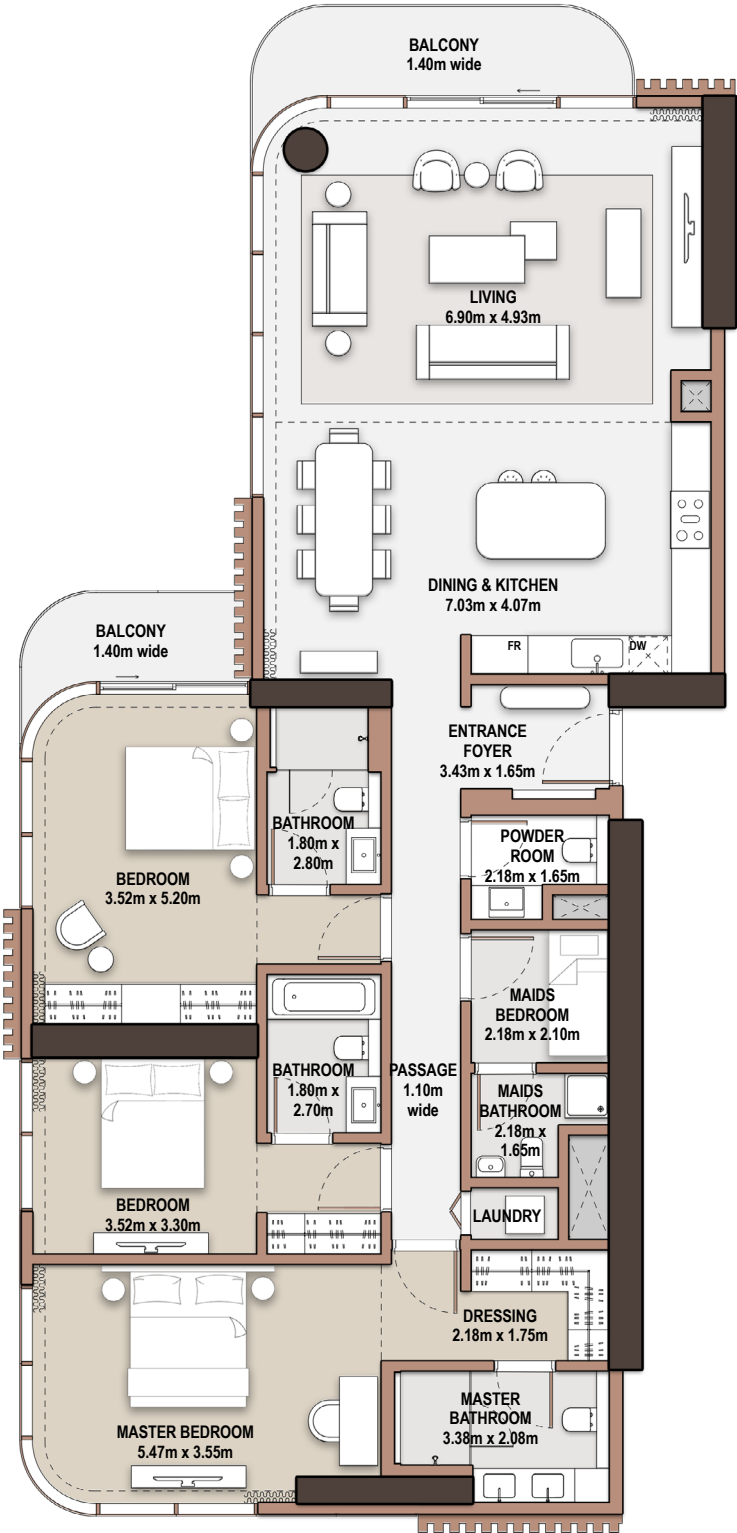

# 3-Bedroom

- *Type* B-3B-E.1

Unit Number			
3103			
Unit Type		Suite Area NIA      SQM   SQFT	
B-3B-E.1		193.64   2,084.32	
Balcony Area	SQM   SQFT	Total Area NSA	SQM   SQFT
17.61   189.55		211.25   2,273.87	

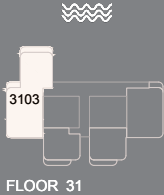
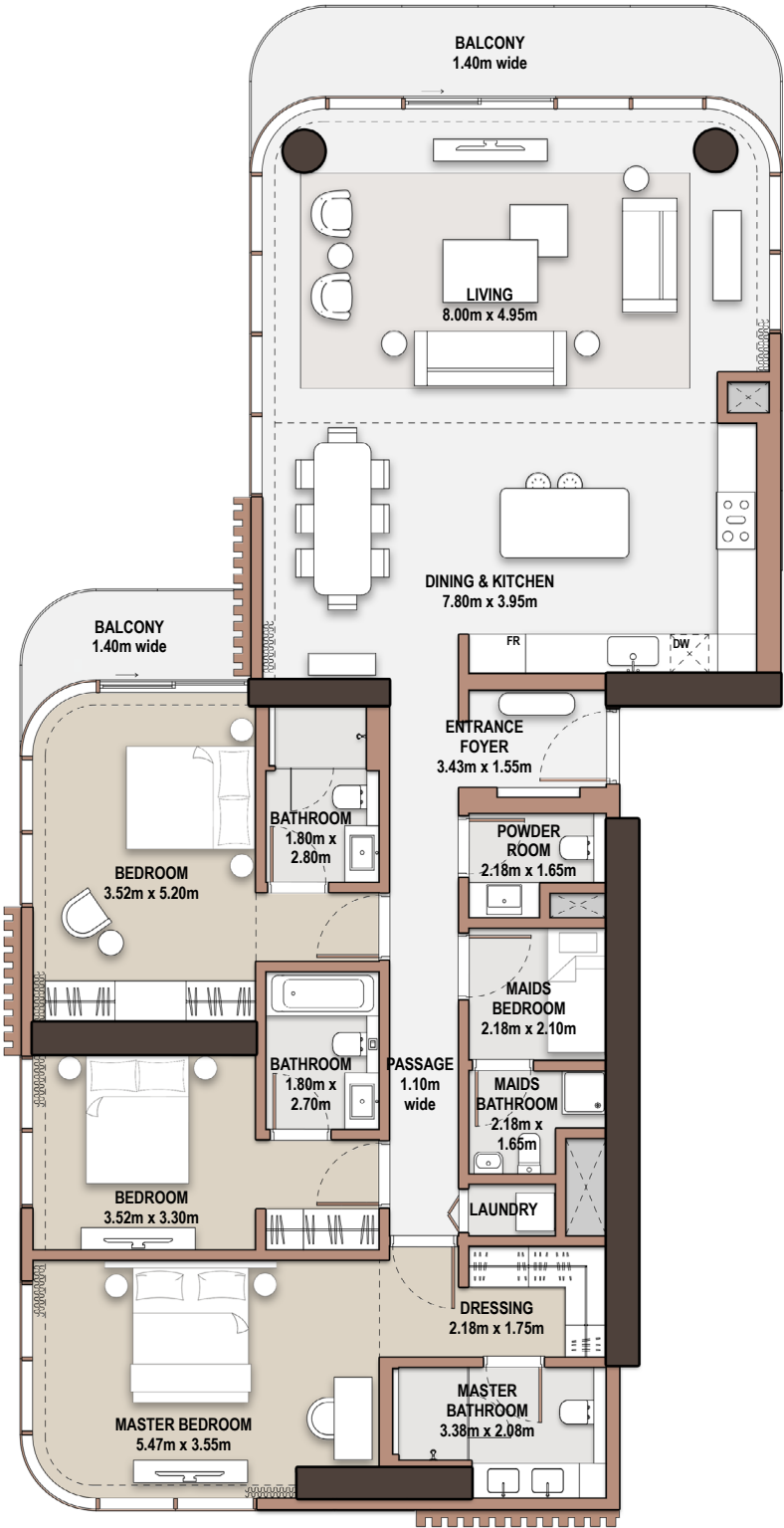

# 3-Bedroom

- Type B-3B-F.1

Unit Number		2102	
Unit Type	Suite Area NIA	SQM   SQFT	
B-3B-F.1	184.94	1,990.68	
Balcony Area	Total Area NSA	SQM   SQFT	
15.55   167.38	200.49	2,158.05	

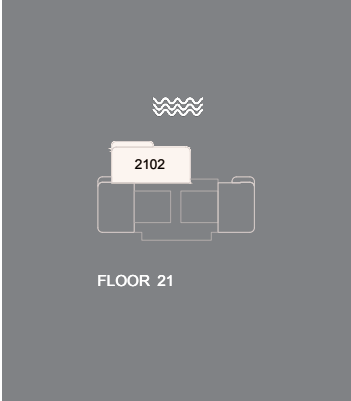
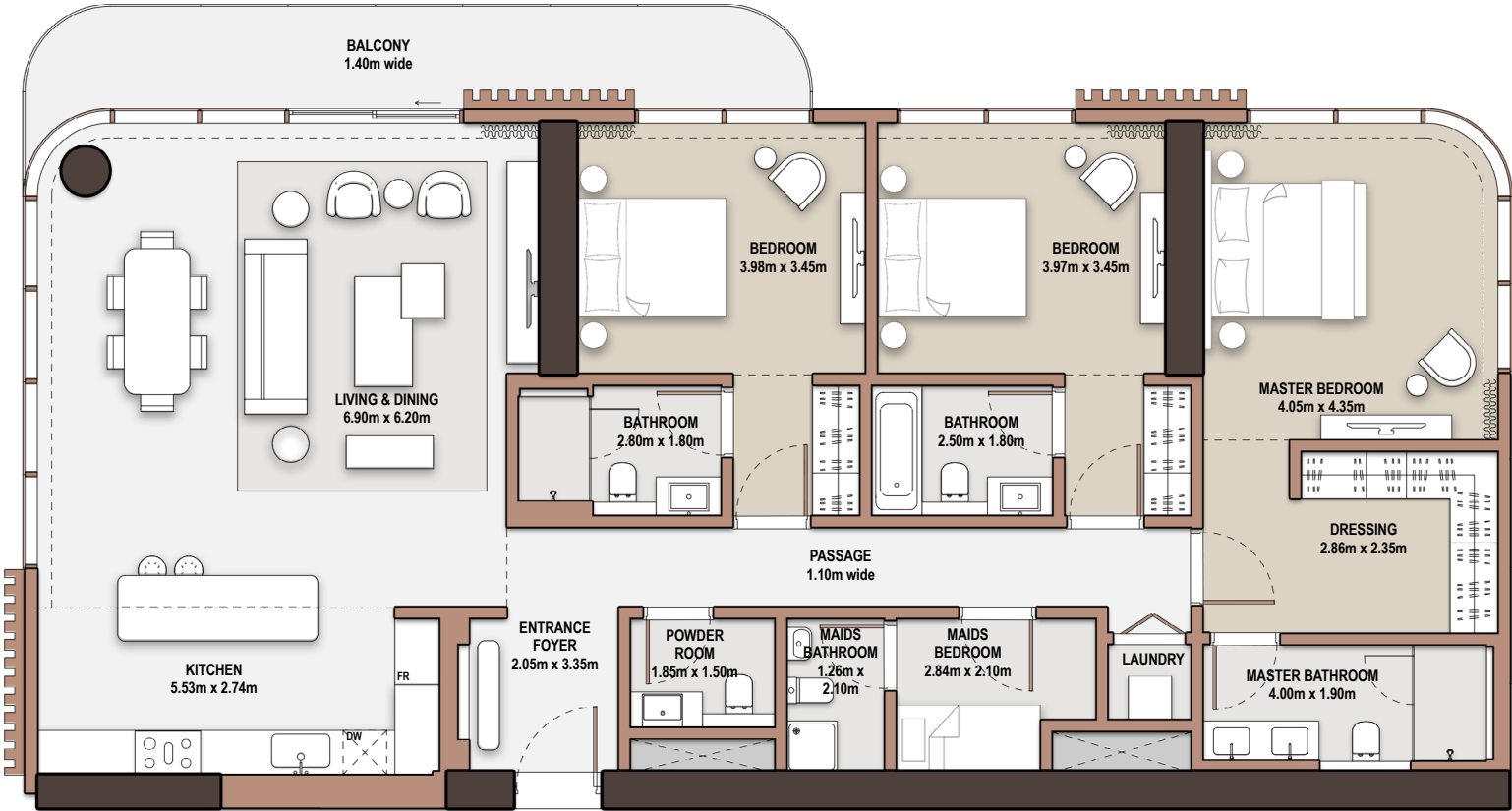

# 3-Bedroom

- Type B-3B-G.1

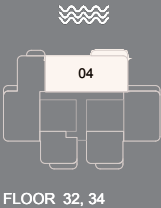

Unit Number		3204, 3404	
Unit Type	Suite Area NIA	SQM   SQFT	
B-3B-G.1	188.45	2,028.46	
Balcony Area	Total Area NSA	SQM   SQFT	
13.52   145.53	201.97	2,173.98	

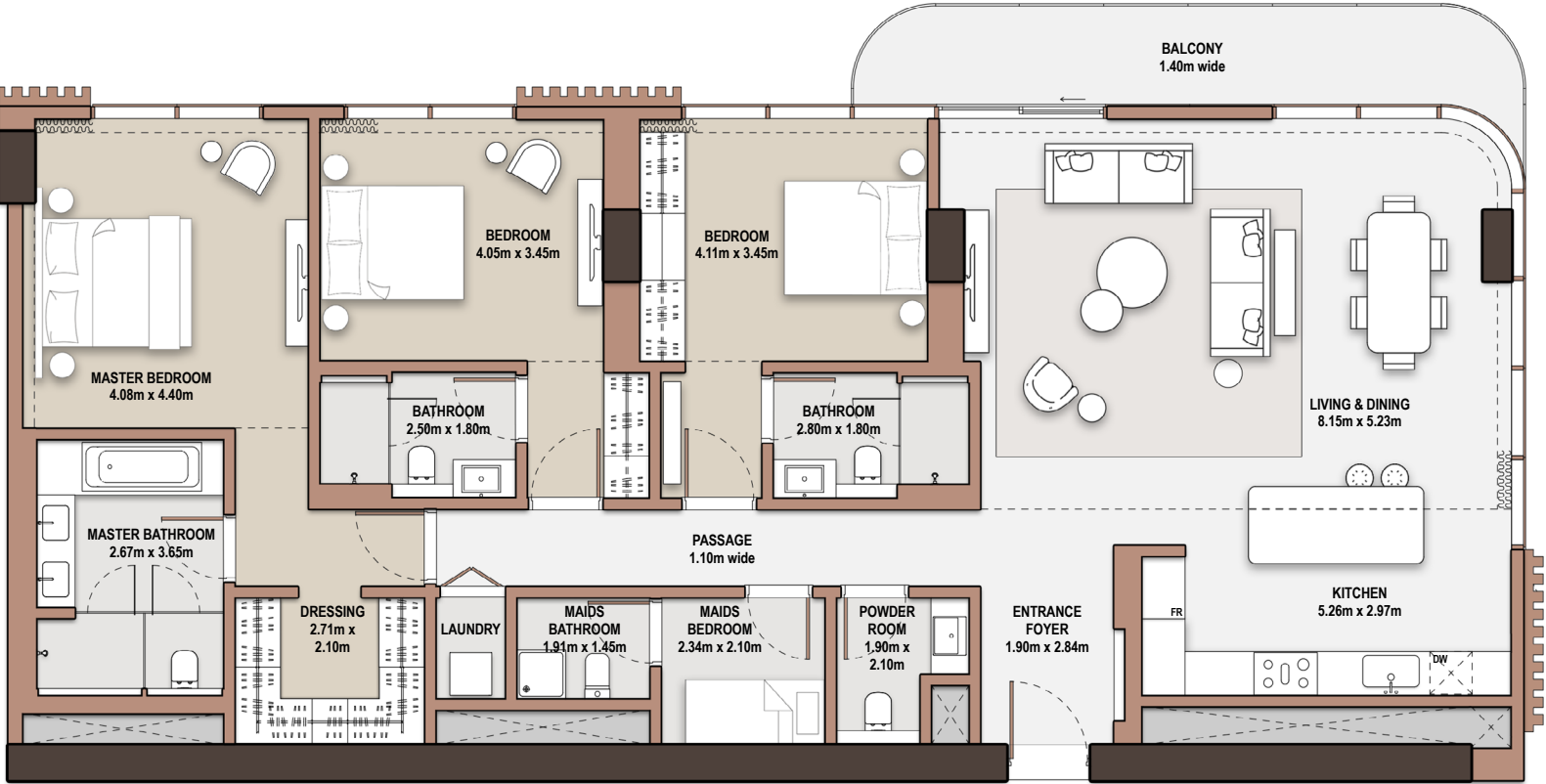

# 3-Bedroom

- Type B-3B-G.2

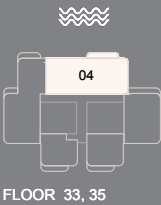

Unit Number		3304, 3504	
Unit Type	Suite Area NIA	SQM   SQFT	
B-3B-G.2	188.45	2,028.46	
Balcony Area	Total Area NSA	SQM   SQFT	
11.39   122.60	199.84	2,151.06	

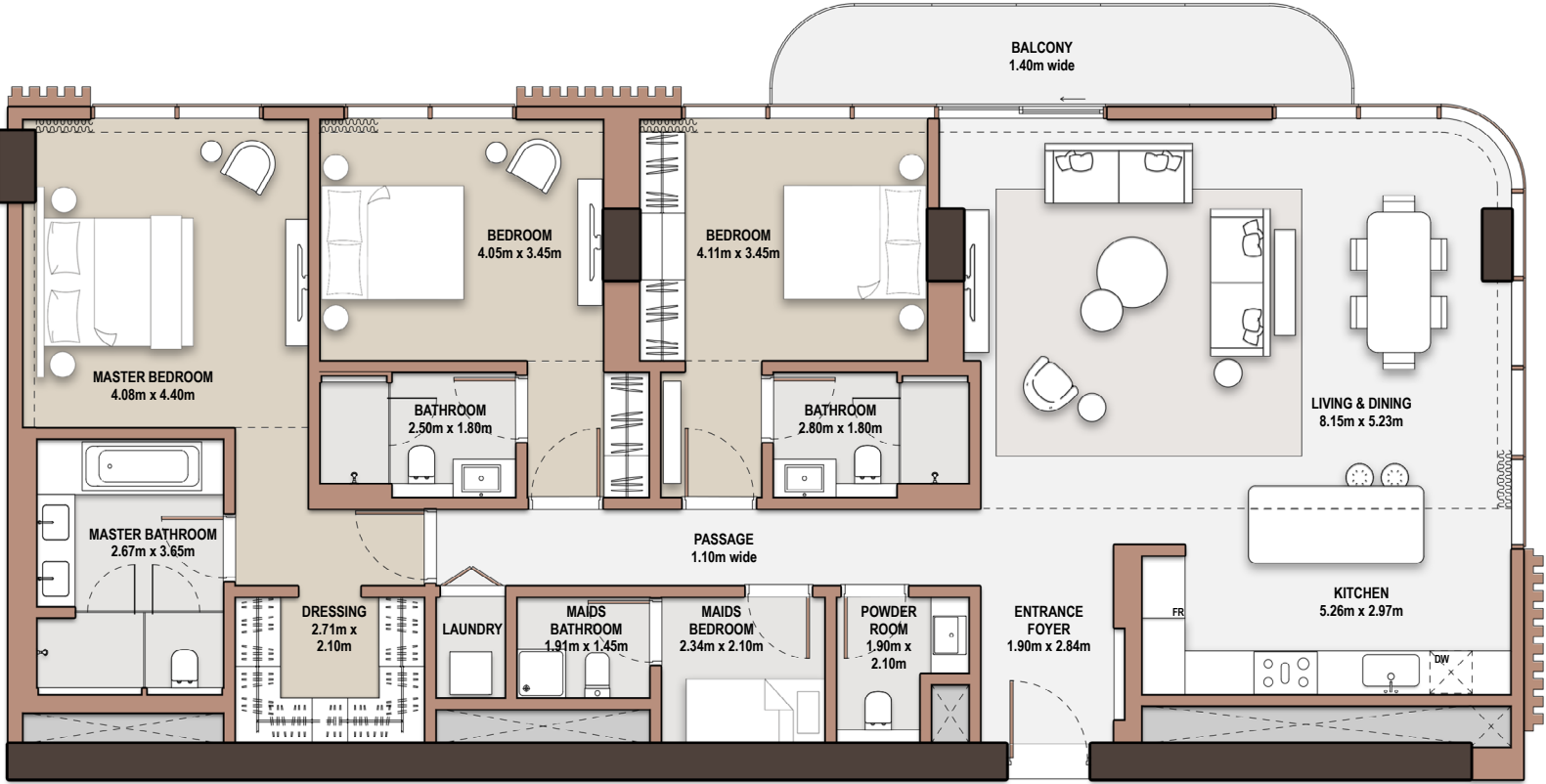



# 4-Bedroom

- *Type* B-4B-A.1



Unit Number 2204, 2404, 2604, 2804			
Unit Type B-4B-A.1	Suite Area NIA	SQM   SQFT	
	233.40	2,512.29	
Balcony Area	SQM   SQFT	Total Area NSA	SQM   SQFT
24.10   259.41		257.50	2,771.70

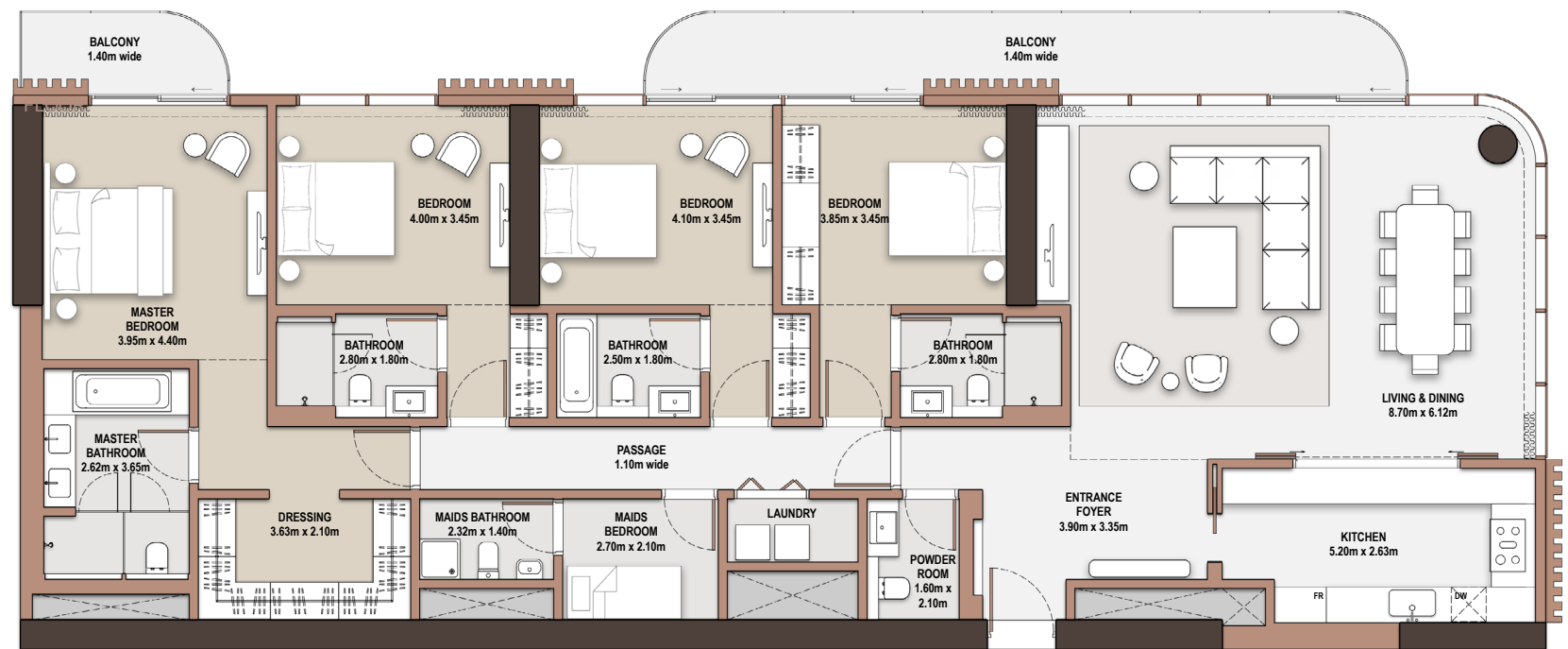

# 4-Bedroom

- *Type* B-4B-B.1



Unit Number 2304, 2504, 2704			
Unit Type B-4B-B.1	Suite Area NIA	SQM   SQFT	
	233.56		2,514.02
Balcony Area	SQM   SQFT	Total Area NSA	SQM   SQFT
27.81	299.34	261.37	2,813.36

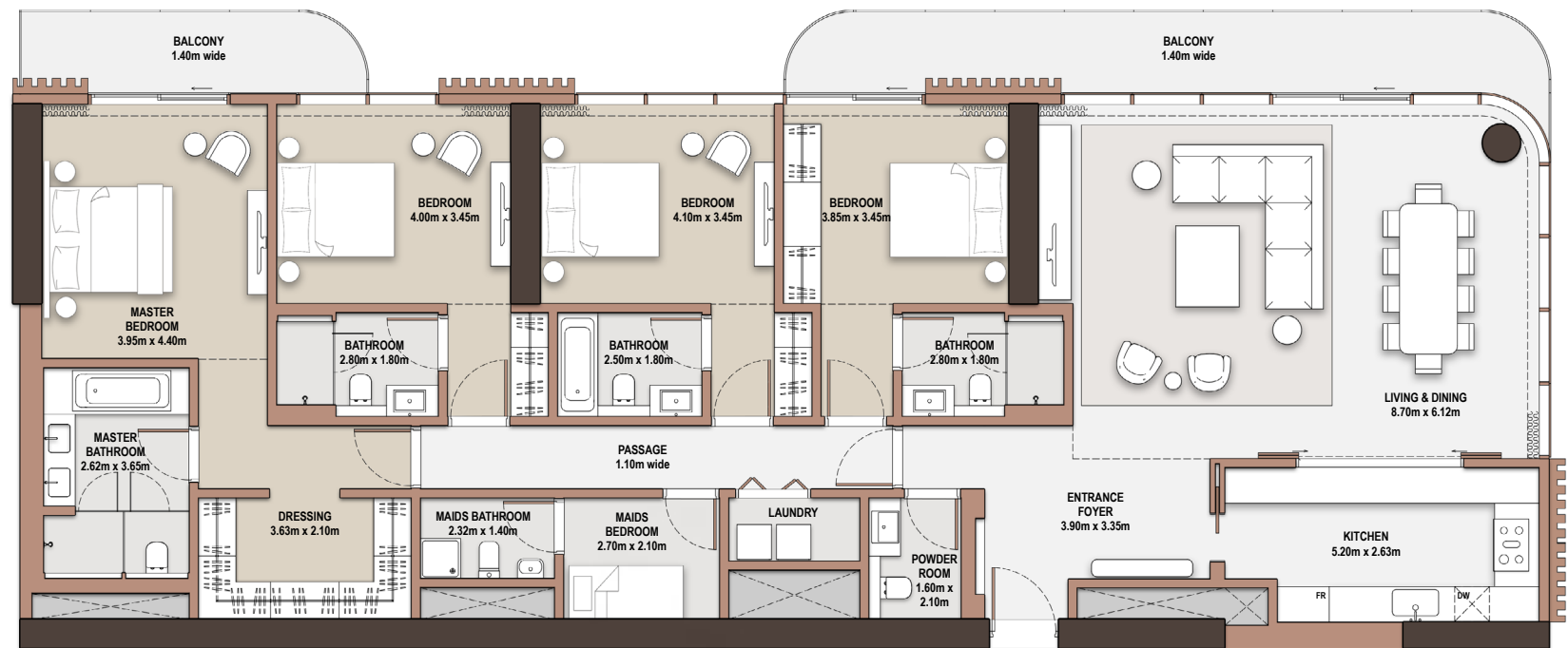

# 5-Bedroom Penthouse

- *Type* B-PH-A - LOWER

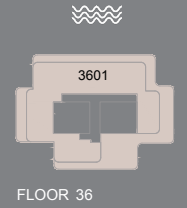

Unit Number		3601	
Unit Type	Suite Area NIA	SQM   SQFT	
B-PH-A	789.36	8,496.59	
Balcony Area	Total Area NSA	SQM   SQFT	
420.84   4,529.88	1210.20	13,026.47	

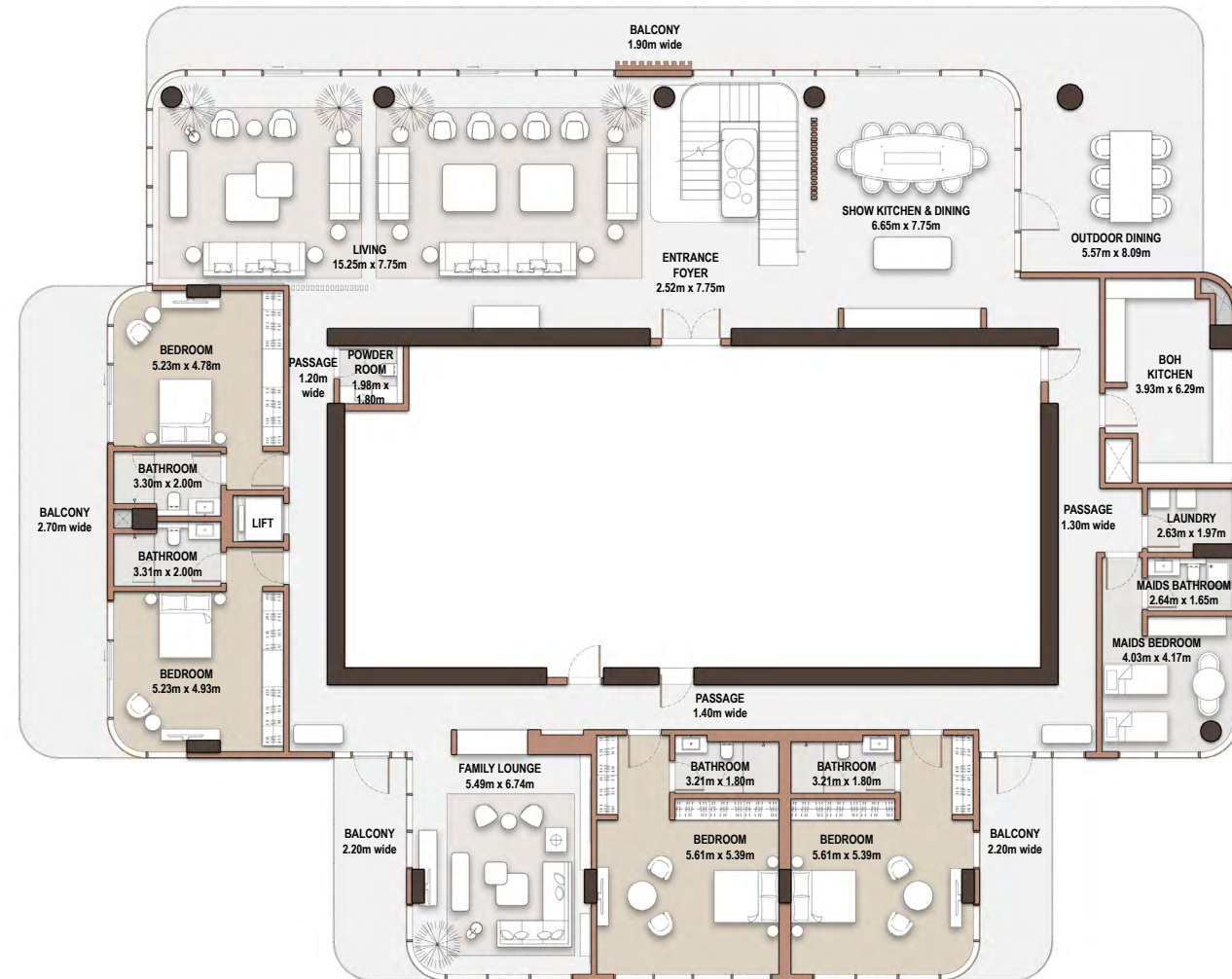

# 5-Bedroom Penthouse

- *Type* B-PH-A - UPPER

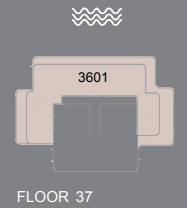

Unit Number		3601	
Unit Type	Suite Area NIA	SQM   SQFT	
B-PH-A	789.36	8,496.59	
Balcony Area	Total Area NSA	SQM   SQFT	
420.84   4,529.88	1210.20	13,026.47	

